

# TEMPORARY LIGHTING SOLUTIONS

## 400 WATT HIGH BAY WORK LIGHT

### FEATURES:

- Fully assembled to save time and labor costs
- Multi-tap ballast: 120V, 208V, 240V, 277V (Factory wired 120V)
- 400W, clear MH pulse start lamp and corrosion resistant welded steel safety cage included. Replacement cages can also be purchased separately
- Meets OSHA requirements for minimum illumination of work areas when properly installed

### APPLICATIONS:

- For use in "High Bay" applications only. Topaz Electric defines High Bay applications as being greater than 25 feet from the floor. UL and cUL listed for damp locations

Two 3/4" knockouts for conduit access for multiple HID fixtures on back

Easy carry handle



Heavy duty corrosion resistant welded steel safety cage included (can also be purchased separately #17400CG)

3 ft. power cord #18/3 SSJTOW with NEMA 5-15120V, 15 amp plug

**UL and cUL Listed for damp locations**  
**Meets EISA 2007 for energy efficiency**  
**Meets NEC 2005 and 2008 requirements**

Vented ballast housing to reduce temperature and overheating

Steel housing, white powder coat finish

Type "O" spring loaded pink porcelain screw shell socket

400W MH pulse start type "O" lamp included (Use Topaz MP400/BU/PS-37 replacement bulb)

Open/close bottom guard 10" opening for easy re-lamping

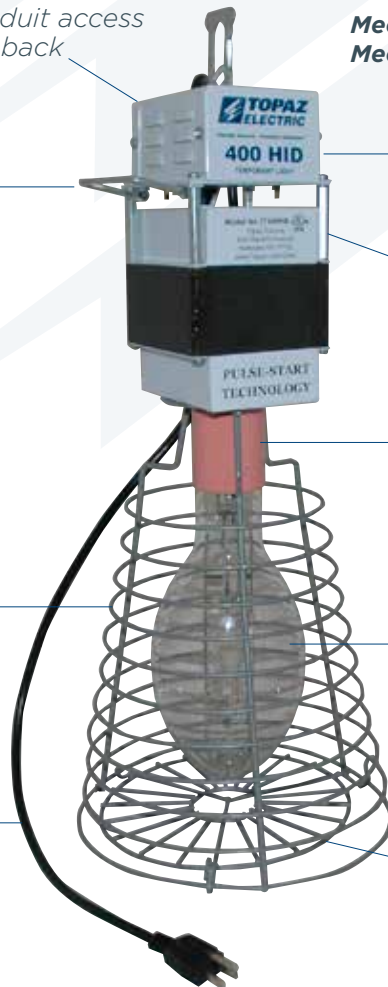

Catalog Number	UPC	Description	Ship Case	Weight/Case
<b>17400HB</b>	86898	400 Watt Temporary High Bay Fixture	1	24
<b>17400CG</b>	86901	Replacement Safety Cage 10" Opening	6	17

# TEMPORARY LIGHTING

**FEATURES:**

- OSHA compliant and UL listed, NEC approved

**APPLICATIONS:**

- Can be used on jobsites, parking lots, nurseries & other locations requiring a temporary light source
- All lighting strings are rated 125V AC, 15A for min. 14/2 and 14/3 cable and 125V AC 20A for min. 12/2 and 12/3 cable. Each lamp holder shall be individually rated for its maximum intended wattage lamp. The maximum wattage rating of an individual lamp holder shall not exceed 150W.



Catalog Number	Description	UPC	Trade Size	Unit Ctn.	Quantity	Weight/Case
1782	Temp. lighting molded cord	84010	14-2	1	100 Ft.	11
1783	Temp. lighting flat wire pin type socket	84011	14-2	1	100 Ft.	10
1780	Yellow plastic cage medium base lamp socket	84008		100	100	15
1781	Metal replacement cage	84009		10	10	11
1780S	Yellow plastic cage for pin type socket	87126		100	100	15

All lighting strings are rated 125V AC, 15A for min. 14/2 and 14/3 cable and 125V AC 20A for min. 12/2 and 12/3 cable. Each lamp holder shall be individually rated for its maximum intended wattage lamp. The maximum wattage rating of an individual lamp holder shall not exceed 150W.

# VAPORPROOF FIXTURE

**FEATURES:** All assembled fixtures are equipped with 5 holes and available with 1/2" & 3/4" threaded holes. Socket with leads, heat resistant glass globe, prevents moisture entry. Industrial grade, fully gasketed. Designed to protect the interior from deteriorating effect of ice, corrosive fumes and non-explosive vapors

**APPLICATIONS:** Ceiling, wall & pendant mount, can be used in wet locations

**STANDARD MATERIAL:** Rugged die cast copper free aluminum

**STANDARD FINISH:** Gray powder coat finish for maximum durability



*UL Listing: Suitable for wet locations in dwellings. Suitable for use with 90° C supply wiring. Complies with UL Standard 1598. For non-hazardous locations where the lamp, socket and wiring require protection from rain, corrosive fumes, non-explosive vapors and gases. Approved for maximum 100W incandescent.*

Catalog Number	UPC	# of Holes	Thread Size	Ship Case	Weight/ Case	A	B
<b>VF1100W50</b>	83868	5	1/2"	6	13	5.25	8.5
<b>VF1100W75</b>	83869	5	3/4"	6	13	5.25	8.5
<b>VF1100W50CG</b>	85156	5	1/2"	6	16	5.25	9.0
<b>VF1100W75CG</b>	85157	5	3/4"	6	16	5.25	9.0
<b>VF1200W50CG</b>	85561	5	1/2"	6	16	5.25	11.5
<b>VF1200W75CG</b>	85562	5	3/4"	6	16	5.25	11.5
<b>VFIBOX50</b>	83872	5	1/2"	12	13	5.25	3.5
<b>VFIBOX75</b>	83871	5	3/4"	12	13	5.25	3.5

## VICTOR SPLIT KNOB

### APPLICATIONS:

For running temporary lighting

### STANDARD MATERIAL:

Glazed porcelain

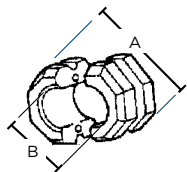

## PIGTAIL SOCKET

### FEATURES:

Right handed thread, left handed thread, #14 stranded, 60/600V

**APPLICATIONS:** Medium base for use in electrical equipment, harnesses, light strings and related applications. Wire leads are color-coded stranded wire, stripped at the ends for easy connection. Rubber sockets have an extended lip to seal against bulb. Metal shell interiors are aluminum, 145 nickel-plated copper. T124L for use with left hand bulbs.



### STANDARD MATERIAL:

Rubber

Catalog Number	UPC	Description	Unit Ctn.	Ship Case	Weight/ Case	A	B
<b>T124</b>	33517	Pigtail Socket - 6" Long	25	250	32	---	---
<b>T124L</b>	85697	Pigtail Socket - 6" Long Left Hand	25	250	32	---	---
<b>V22</b>	33515	Victor Split Knob - 1"	-	100	38	2.125	1.00
<b>V38</b>	33516	Victor Split Knob - 1-1/2"	-	50	104	3.00	1.50