

# Product data sheet

## Characteristics

# XZCC43FCP40B

female, DIN 43650 A, 4-pin, elbowed connector - cable gland Pg 11

Product availability : Stock - Normally stocked in distribution facility



### Main

Accessory / separate part category	Cabling accessories
Accessory / separate part type	Connector
Electrical connection	Elbowed female connector DIN 43650 A, 4 pins
Status LED	Without
Cable connection	Screw terminal / wire size $\leq 0 \text{ in}^2 (1.5 \text{ mm}^2)$ / clamping capacity 0.28...0.39 in (7...10 mm)

### Complementary

Cable gland type	Pg 11
Cable connector fixing	Locking screw
System Voltage	250 V AC
Line Rated Current	16 A
Enclosure material	Plastic
Insulating resistance	$> 0.1 \text{ G}\Omega$
Contact resistance	$\leq 4000 \mu\text{Ohm}$
Product weight	0.08 lb(US) (0.035 kg)

### Environment

IP degree of protection	IP65
Ambient air temperature for operation	-40...257 °F (-40...125 °C)

### Ordering and shipping details

Category	22483 - MACHINE CABLES
Discount Schedule	DS3
GTIN	00785901169154
Nbr. of units in pkg.	1
Package weight(Lbs)	7.0000000000000007E-2

Returnability	Y
Country of origin	DE

### Offer Sustainability

Sustainable offer status	Not Green Premium product
RoHS (date code: YYWW)	Compliant - since 0726 - Schneider Electric declaration of conformity <a href="#">Schneider Electric declaration of conformity</a>

### Contractual warranty

Warranty period	18 months
-----------------	-----------

Dimensions

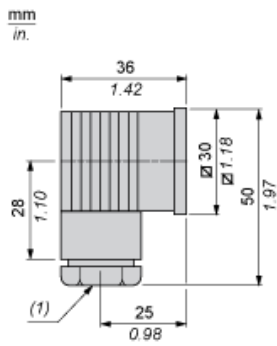

(1) Pg 11 cable gland

---

Connections and Schemes

---

