

FEATURES

OPTICAL SYSTEM

- Self-flanged, semi-specular, matte-diffuse, or specular reflector. Patented Bounding Ray™ Optical Principle design (U.S. Patent No. 5,800,050) provides lamp before lamp image and smooth transition from top of the reflector to bottom. Minimum flange matches reflector finish.

MECHANICAL SYSTEM

- 16-gauge galvanized steel mounting/plaster frame with integral yoke to retain optical system. Maximum 2-1/4" ceiling thickness.
- 16-gauge galvanized steel mounting bars with continuous 4" vertical adjustment are shipped pre-installed. Post-installation adjustment possible without the use of tools from above or below ceiling.
- Galvanized steel junction box with bottom-hinge access covers and spring latch. Two combination 1/2"-3/4" and three 1/2" knockouts for straight-through conduit runs. Capacity: 8 (4 in, 4 out) No. 12 AWG conductors, rated for 90°C.

ELECTRICAL SYSTEM

- Horizontally mounted, positive-latch, thermoplastic socket.
- Class P, thermally protected high-power-factor ballast(s) mounted to the junction box.
- Simply5™ technology available. SIMPLY5 LIGHTING INTELLIGENCE

LISTING

- Fixtures are UL listed for thru-branch wiring, non-IC recessed mounting and damp locations. Listed and labeled to comply with Canadian standards.

WARRANTY

- One-year limited warranty. Full warranty terms located at www.acuitybrands.com/CustomerResources/Terms_and_conditions.aspx

ORDERING INFORMATION

Choose the boldface catalog nomenclature that best suits your needs and write it on the appropriate line. Order accessories as separate catalog numbers (shipped separately).

AF

Series	Wattage/Lamp	Aperture/Trim color	Finish	Voltage	Ballast ³	Options
--------	--------------	---------------------	--------	---------	----------------------	---------

AF	1/13DTT	8AR Clear	(blank) Semi-	MVOLT²	(blank) Electronic ballast	DS Dual switching
	2/13DTT	8PR Pewter	Specular	120	ECOS^{2,4} Lutron EcoSystem® electronic dimming ballast. Minimum dimming level 5%	EL⁷ Emergency battery pack. Integral test switch provided
	1/18DTT	8WTR Wheat	LD Matte-diffuse	277	ADEZ^{4,5} Advance Mark10® electronic dimming ballast. Minimum dimming level 5%	ELR⁷ Emergency battery pack. Remote test switch provided
	2/18DTT	8BC¹ Black cone		347	ADZT^{4,5} Advance Mark 7® electronic dimming ballast. Minimum dimming level 5%	ELHL⁷ High lumen output emergency battery pack. Integral test switch provided
	1/26DTT	8MB¹ Black baffle			S5⁵ SIMPLY5™ dimming system. Minimum dimming level 15%	ELRHL⁷ High lumen output emergency battery pack. Remote test switch provided
	2/26DTT	8WR¹ White painted				GMF⁵ Single slow-blow fuse
		8WB¹ White baffle				GLR⁵ Single fast-blow fuse
						WLP With 3500 K lamp (shipped separately)
						TRW White painted flange. Standard on MB and WB
						TRBL Black painted flange
					LRC⁸ Provides compatibility with Lithonia Reloc® System. Lithonia Reloc System can be installed less option with connectors provided by others. Access above ceiling required	

NOTES

- 1 Not available with finishes.
- 2 Multi-volt electronic ballast capable of operating on any voltage from 120V through 277V, 50 or 60 Hz.
- 3 For additional ballast types, refer to TECH-250.
- 4 Not available with 13DTT.
- 5 Available in 120V or 277V only.
- 6 SIMPLY5™ includes 9' S5 MLC Reloc wiring system (shipped separately). Available in 120V or 277V only. Available in 26W only. See simply5.net for more information.
- 7 For dimensional changes, refer to TECH-140.
- 8 For compatible Reloc systems, refer to TECH-110.
- 9 Not available with emergency options.
- 10 Meets codes that require in-fixture disconnect.
- 11 One 5A relay with one 0-10 VDC dimming output, shipped installed. Requires additional nLight bus power supply (nPS80).
- 12 Must specify wattage. Ex.: WRL32

Type Catalog number

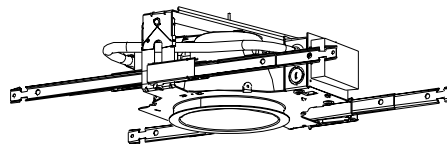

Compact Fluorescent Downlights

8" AF

Open Reflector

Horizontal Lamp
Double Twin-Tube

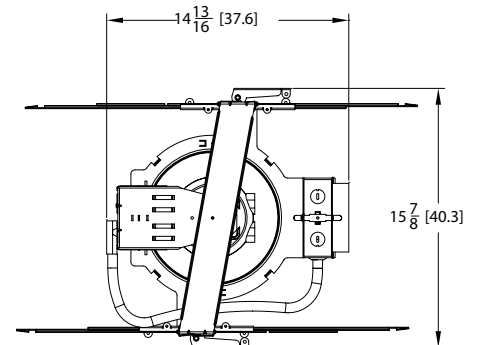

Aperture: 8 (20.3)
Ceiling opening: 8-7/8 (22.5)
Overlap trim: 9-1/4 (23.4)
Lens recess: 2-5/8 (6.7)

All dimensions are inches (centimeters).

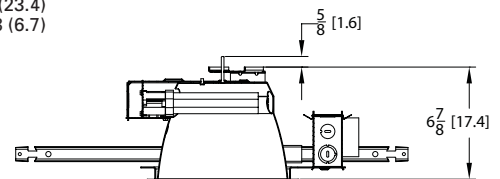

Example: **AF 2/18DTT 8AR MVOLT**

Accessories

Order as separate catalog number.

SCA8 Sloped ceiling adapter. Degree of slope must be specified (10D, 15D, 20D, 25D, 30D). Ex: SCA8 10D.

- GMF⁵** Single slow-blow fuse
- GLR⁵** Single fast-blow fuse
- WLP** With 3500 K lamp (shipped separately)
- TRW** White painted flange. Standard on MB and WB
- TRBL** Black painted flange
- LRC⁸** Provides compatibility with Lithonia Reloc® System. Lithonia Reloc System can be installed less option with connectors provided by others. Access above ceiling required
- HW** Hardwire for S5 system; replaces Reloc
- CP⁹** Chicago plenum
- BDP¹⁰** Ballast disconnect plug
- NSD¹¹** Sensor Switch nLight™ dimming relay
- WRL¹²** Wattage restriction label

8" AF Open Reflector

Distribution curve	Distribution data	Output data	Coefficient of utilization	Illuminance Data at 30" Above Floor for a Single Luminaire
--------------------	-------------------	-------------	----------------------------	--

AF 2/18DTT 8AR, (2) CF18DD/E/835 lamp, 2500 total rated lumens, test no. LTL10614

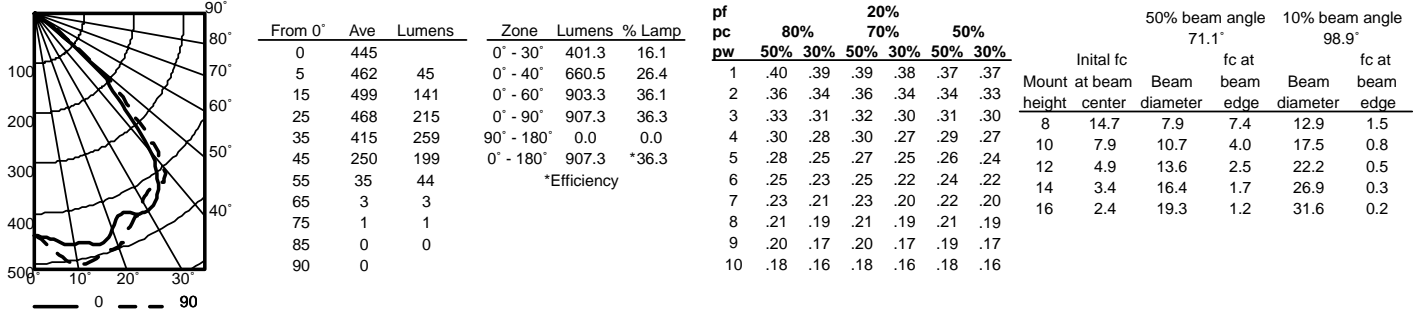

AF 2/26DTT 8AR, (2) CF26/DD/E/835 lamp, 3600 total rated lumens, test no. LTL10615

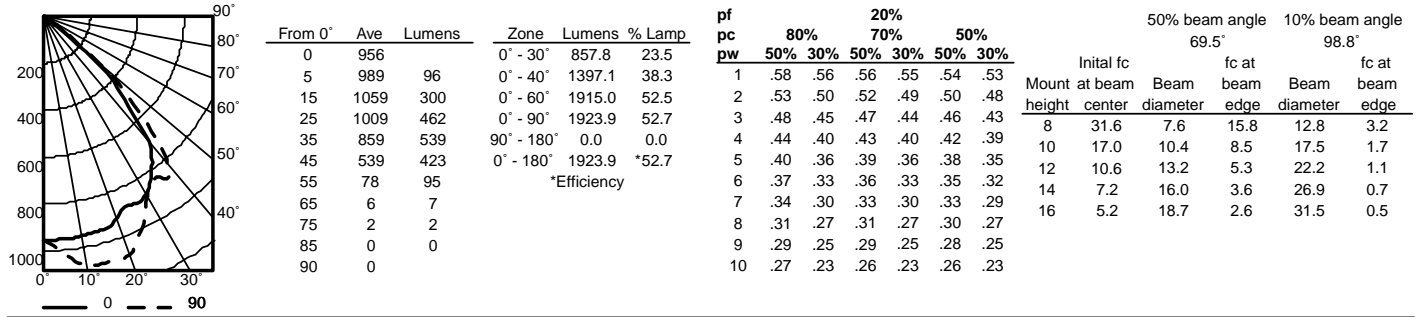

AF 2/26DTT 8BC, (2) CF26DD/E/835 lamp, 3600 total rated lumens, test no. LTL10946

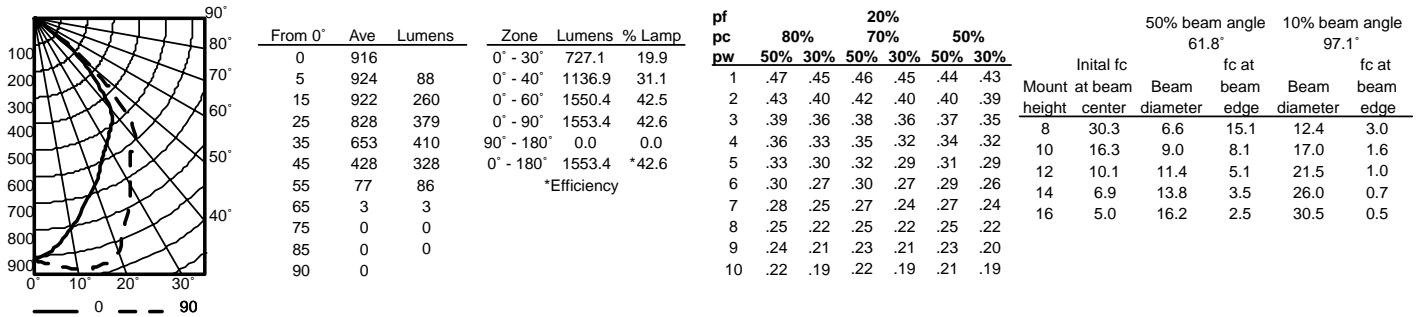

AF 2/26DTT 8MB, (2) CF26DD/E/835 lamp, 3600 total rated lumens, test no. LTL10982

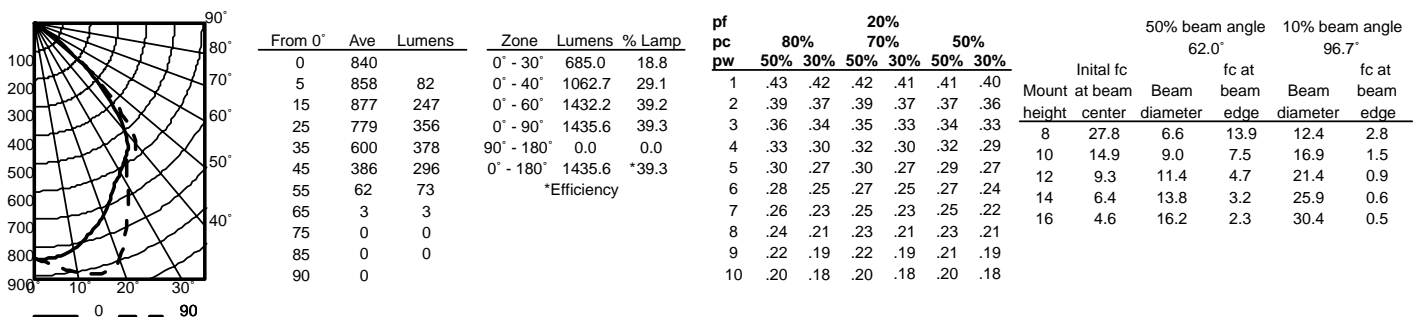

NOTES:

- For electrical characteristics consult technical data tab.
- Tested to current IES and NEMA standards under stabilized laboratory conditions. Various operating factors can cause differences between laboratory data and actual field measurements. Dimensions and specifications are based on the most current available data and are subject to change without notice.
- Actual performance may differ as a result of end-user environment and application.

DCF-220

©2003, 2011 Acuity Brands Lighting, Inc.
 All Rights Reserved. Rev. 12/11
 Specifications subject to change without notice.



GOTHAM ARCHITECTURAL DOWNLIGHTING
 1400 Lester Road Conyers Georgia 30012
 P 800 315 4982 F 770 860 3129
 www.gothamlighting.com