

PRODUCT INFORMATION

# TSP

Tru-Sport®



**Intended Use**

For stadiums, fields, arenas, tracks or courts.

**Construction**

Housing: Two-piece, die-cast aluminum ballast housing mounted to steel trunnion. Removable ballast is hinged with captive fastener. Steel trunnion features both vertical and horizontal aiming scale with vertical repositioning stop. Standard finish is white (DWH) corrosion-resistant polyester powder. Additional architectural colors available; see [www.lithonia.com/archcolors](http://www.lithonia.com/archcolors).

**Optics**

Heavy-gauge anodized reflector with five distributions available. Transverse mounting of lamp. Lamp support included. Optical chamber is sealed to inhibit entrance of contaminants. Heavy-duty hinged lens is thermal-resistant, shock-resistant and impact-resistant tempered glass. Lens frame is secured by spring clips for servicing of lamp. "Flux manager" (NFX, WFX, MFX) available for optimal glare and spill light control. Choice of general purpose or heavy-duty (shrouded) reflectors.

**Electrical**

All electrical components are thermally isolated from optical assembly, promoting longer life. All ballasts are 100% factory tested. Constant wattage autotransformer 400W and above. Super CWA Pulse Start ballast, 88% efficient and EISA legislation compliant, is required for 400W (must order SCWA option) for U.S. shipments only. CSA, NOM or INTL required for probe start shipments outside the U.S.

Socket: Die-cast socket housing. Porcelain, mogul-base socket with copper alloy, nickel-plated screw shell and

spring-loaded center contact. UL Listed 1500W-600V, 4KV pulse rated.

**Installation**

Fixture is mounted by securing trunnion directly to crossarm. Mounting hardware is provided. Below horizontal aiming only. All external hardware is treated for corrosion resistance.

**Listings**

UL Listed (standard). CSA Certified (see Options). UL Listed for 25°C ambient and wet locations. US Patent No. 6,190,023. Canadian Patent No. 2,212,014. Other patents pending.



**ORDERING INFORMATION**

For shortest lead times, configure products using **bolded options**.

**Example:** TSP 1500M GP24N TB

Wattage	Lamp type	Distribution	Voltage	Ballast	Mounting	
<b>TSP</b>	400M	General purpose	120	<b>(blank)</b> Magnetic ballast	<u>Ships installed</u>	<b>FCRA45</b> Crossarm adaptor (45° from horizontal)
	<b>1000M</b>	GP24N	208 <sup>3</sup>	CWI Constant wattage isolated <sup>5</sup>	<b>(blank)</b> Yoke (std.)	FPMB Wall/pole mounting bracket
	<b>1500M<sup>1</sup></b>	GP24NFX	240 <sup>3</sup>	SCWA Super CWA ballast	<u>Ships separately<sup>6</sup></u>	FSAB Steel angle bracket
		GP24M	277		FRWB Radius wall bracket	FCX2 2-Light wood pole crossarm
		GP24MFX	<b>347</b>		FTS Tenon slipfitter (2-3/8" to 2-7/8" OD tenon)	FCX3 3-Light wood pole crossarm
		GP24W	480 <sup>3</sup>		FCRA Crossarm adaptor	FCX4 4-Light wood pole crossarm
	GP24WFX	HD24WFX	<b>TB<sup>4</sup></b> 23050HZ <sup>5</sup>			
<b>Options</b>						<b>Finish</b>
SF	Single fuse, 120V, 277V, 347V			SLR	Stainless steel lens ring	<b>(blank)</b> White (std.)
DF	Double fuse, 208V, 240V, 480V			WC	Mounting bolt for wooden crossarm	DDB Dark bronze
QRS	Quartz restrike system <sup>7</sup>			CSA	Meets Canadian standards	DBL Black
C22	2' 12-3 cord prewired			NOM	Meets Mexican standards (consult factory)	DMB Medium bronze
C42	2' 14-3 cord prewired			INTL	Available for MH probe start shipping outside the U.S.	DNA Natural aluminum
C62	2' 16-3 cord prewired					<b>CR</b> Enhanced corrosion resistance
CV3P	3' of 16-3 cord prewired with 3-prong plug for use with prewired cages <sup>8</sup>					<b>CRT</b> Non-stick protective coating (black)
CF	Charcoal filter <sup>9</sup>					

**ADDITIONAL INFORMATION**

For additional product information, visit [www.lithonia.com](http://www.lithonia.com).

Drawings are for dimensional detail only and may not represent actual mechanical configuration. Dimensions are shown in inches (centimeters) unless otherwise noted.

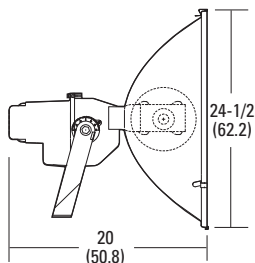

EPA: 3.3 ft<sup>2</sup> (0.91m<sup>2</sup>)  
Max weight: 55 lbs (24.9 kg)

**Notes**

- 1 Not available with SCWA.
- 2 Heavy-duty anodized aluminum shroud painted to match fixture.
- 3 Must specify CWI for use in Canada.
- 4 Optional multi-tap ballast (120V, 208V, 240V, 277V). In Canada 120V, 277V, 347V; ships as 120V/347V.
- 5 Consult factory for available wattages.
- 6 May be ordered as an accessory. Must specify finish.
- 7 Maximum allowable wattage lamp included.
- 8 Must use mating receptacle, provided by others (N/A 1500M 120V).
- 9 HD option must be ordered.