



# 10" SQUARE IC HOUSING

## INCANDESCENT LAMPS

### IC7

Project: \_\_\_\_\_

Fixture Type: \_\_\_\_\_

Location: \_\_\_\_\_

Contact/Phone: \_\_\_\_\_

### PRODUCT DESCRIPTION

IC Double wall housing construction • Can be completely covered with insulation.

### PRODUCT SPECIFICATIONS

**Lamp** One 100W A19 lamp.

**Socket** Medium base porcelain with nickel-plated copper screw shell.

**Trims** Trim selection shown below.

**Labels** UL listed for through-branch wiring, damp locations and IP  
• Product thermally protected against improper use of insulation  
• Union made • UL Listed/CSA certified.

**Testing** All reports are based on published industry procedures; field performance may differ from laboratory performance.  
Specifications subject to change without notice.

### INSTALLATION

**Real Nail® 3 Bar Hangers** Telescoping, Patented (US Patent D552,969) Real Nail 3 system permits quick placement of housing anywhere within 24" O.C. joists or suspended ceilings • Integral T-bar notch and clip secures housing in suspended ceiling grid – no accessory clips required • 24" expansion stop allows quick placement of fixture in standard grid spacing • Bars scored in two locations for fast, clean breaking, allowing housing installation in tight applications • Bars captive to mounting frame • Edge-mounted for extra strength • Captive bugle-headed ring shank nail for quick one-step installation and easy removal with claw hammer for fixture relocation • Quick-Loc slot and oversized locking set screw lock fixture in position • Bar hanger foot contoured to align to bottom of construction joist • Alternate mounting holes included.

**Junction Box** Pre-wired junction box provided with (5) ½" and (1) ¾" knockouts, (4) Romex connectors and ground wire, UL listed/CSA certified for through-branch wiring, maximum 8 No. 12 AWG 90° C branch circuit conductors (4 in, 4 out) • Junction box provided with removable access plates • Knockouts equipped with pryout slots.

**Mounting Frame** 22-gauge die-formed galvanized steel mounting frame • 16½" L x 11¾" W, (excluding bar hangers) • Rough-in section (junction box, mounting frame, housing and bar hangers) fully assembled for ease of installation.

**Housing** IC housing, .032" aluminum • Housing is vertically adjustable to accommodate up to a 1" ceiling thickness.

### DIMENSIONS

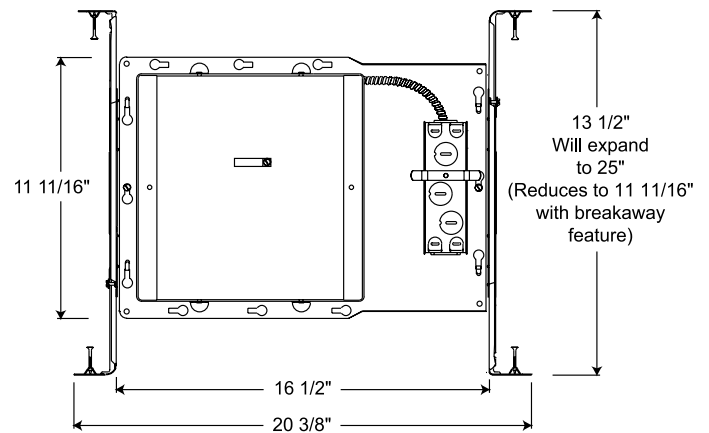
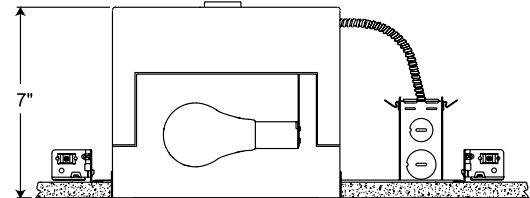

10 5/8" SQ. CEILING CUTOUT

### PRODUCT CODES

Catalog Number	Input Voltage	Lamp Rating
IC7 10" Incandescent Square IC New Construction Housing	120V	100W A19

### TRIMS/LAMPS

Catalog Number	Description	Max. Lamp Rating
70 WH	10" Crystal Diffuser Trim, White	100W A19
71 WH	10" Drop Opal Trim, White	100W A19
Trim Size: 11 1/8" SQ.		

Housing and trim can be ordered together or separate, but will always ship separately.

