

Sheet Metal Tools/HVAC

Klein's line of sheet metal and HVAC tools make it easy to work with sheet metal, ductwork and tubing. These job-matched tools are proven to stand the test of time with superior results.

F O R P R O F E S S I O N A L S . . . S I N C E 1 8 5 7 ®



Sheet Metal Tools/HVAC

HVAC



Cutting & Notching Tools – Journeyman™ Snips

Features:

JOURNEYMAN™

Exclusive Klein Curve® design for added comfort.

Soft black material on outer surface for comfort and a firm grip.

Self opening latch.

Long-lasting serrated forged steel blades for superior strength and durability.

Hard, colored material for toughness and durability.

Premium corrosion-resistant plated handles.



Tip-Ident® for easy identification.

Meets or exceeds ASME B107.16M performance standard.



Aviation Snips

JOURNEYMAN™

Additional Features:

- Soft touch grips for maximum control and comfort.
- J1100L, J1101R, J1102S Journeyman snips cut 18 gauge cold rolled steel and 22 gauge stainless steel.
- J2103S Journeyman Bulldog snips cut 16 gauge cold rolled steel and 18 gauge stainless steel.



J1102S



J1101R



J1100L

| Cat. No. | Cutting Pattern | Snip Type | Length of Cut | Color Code | Overall Length | Cutting Capacity: Cold Rolled/Stainless Steel | Weight (oz.) |
|----------|----------------------|-----------|----------------|--------------|-------------------|---|--------------|
| J1100L | left/straight | aviation | 1-3/8" (35 mm) | red/black | 9-7/8" (250 mm) | 18 gauge/22 gauge | 14.4 |
| J1101R | right/straight | aviation | 1-3/8" (35 mm) | green/black | 9-7/8" (250 mm) | 18 gauge/22 gauge | 14.7 |
| J1102S | straight/wide curves | aviation | 1-1/2" (38 mm) | yellow/black | 10-1/16" (255 mm) | 18 gauge/22 gauge | 14.4 |
| J2103S | notch/straight | bulldog | 7/8" (22 mm) | yellow/black | 9-7/16" (240 mm) | 16 gauge/18 gauge | 13.9 |

Right Angle Snips

JOURNEYMAN™

Additional Features:

- Soft touch grips for maximum control and comfort.
- J2104L, J2105R Journeyman snips cut straight, curves, and tight circles in 24 gauge cold rolled steel and 28 gauge stainless steel.
- Makes cutting easier in confined spaces (in ductwork, reaching through openings or against a wall).



J2105R



J2104L

| Cat. No. | Cutting Pattern | Snip Type | Length of Cut | Color Code | Overall Length | Cutting Capacity: Cold Rolled/Stainless Steel | Weight (oz.) |
|----------|-------------------------------------|-------------|----------------|-------------|-------------------|---|--------------|
| J2104L | left curves/tight circles/straight | right angle | 1-1/4" (32 mm) | red/black | 7-15/16" (201 mm) | 24 gauge/28 gauge | 14.4 |
| J2105R | right curves/tight circles/straight | right angle | 1-1/4" (32 mm) | green/black | 7-15/16" (201 mm) | 24 gauge/28 gauge | 14.4 |

All dimensions are in inches and (millimeters).

⚠WARNING: Always wear approved eye protection.

⚠WARNING: Never use on or near live electrical circuits

⚠WARNING: NOT insulated. Will NOT protect against electrical shock.



Cutting & Notching Tools – Journeyman™ Snips

Offset Snips

JOURNEYMAN™

Additional Features:

- Soft touch grips for maximum control and comfort.
- J2100L, J2101R, J2102S and J2106S snips feature exclusive Klein Kurve® handles for natural hand positioning and ease of use.
- J2106S Journeyman snips cut 20 gauge cold rolled steel and 24 gauge stainless steel, with a 2-3/8" length of cut for faster cutting.
- J2100L, J2101R and J2102S Journeyman snips cut 18 gauge cold rolled steel and 22 gauge stainless steel.



| Cat. No. | Cutting Pattern | Snip Type | Length of Cut | Color Code | Overall Length | Cutting Capacity: Cold Rolled/Stainless Steel | Weight (oz.) |
|----------|----------------------|-----------------|----------------|--------------|------------------|---|--------------|
| J2100L | left/straight | offset | 1-1/4" (32 mm) | red/black | 9-1/2" (241 mm) | 18 gauge/22 gauge | 15.5 |
| J2101R | right/straight | offset | 1-1/4" (32 mm) | green/black | 9-1/2" (241 mm) | 18 gauge/22 gauge | 15.7 |
| J2102S | straight/wide curves | offset | 1-1/2" (38 mm) | yellow/black | 9-1/2" (241 mm) | 18 gauge/22 gauge | 15.5 |
| J2106S | straight/wide curves | long cut offset | 2-3/8" (38 mm) | yellow/black | 10-1/2" (266 mm) | 20 gauge/24 gauge | 18.2 |

Cutting & Notching Tools

Aviation Snips – Regular/Offset/Bulldog

- Forged and heat-treated steel blades for strength and durability.
- Regular and offset blades have the capacity of cutting 18 gauge cold-rolled sheet metal and 22 gauge stainless steel sheet metal.
- Offset blades provide ease of cutting tight curves and keep user's hand away from metal.
- Bulldog snips (Cat. No. 2103) for notching or trimming 16 gauge cold-rolled sheet metal and 18 gauge stainless steel sheet metal.
- Spring-loaded for self-opening action.
- Latch keeps jaws closed when not in use.
- Hardened handles for extra strength.
- Contoured plastic handles are comfortable and color-coded by cutting pattern.



| Cat. No. | Cutting Pattern | Snip Type | Length of Cut | Color Code | Overall Length | Cutting Capacity | Weight (oz.) |
|----------|-----------------------|-----------|----------------|------------|------------------|------------------|--------------|
| 1100L | left / straight | aviation | 1-3/8" (35 mm) | red | 9-3/4" (248 mm) | 18 ga. | 14.4 |
| 1101R | right / straight | aviation | 1-3/8" (35 mm) | green | 9-3/4" (248 mm) | 18 ga. | 14.7 |
| 1102S | straight / wide curve | aviation | 1-1/2" (38 mm) | yellow | 10-1/8" (257 mm) | 18 ga. | 14.4 |
| 2100L | left / straight | offset | 1-1/4" (32 mm) | red | 9-1/2" (241 mm) | 18 ga. | 15.5 |
| 2101R | right / straight | offset | 1-1/4" (32 mm) | green | 9-1/2" (241 mm) | 18 ga. | 15.7 |
| 2102S | straight / wide curve | offset | 1-1/2" (38 mm) | yellow | 9-1/2" (241 mm) | 18 ga. | 15.5 |
| 2103 | notch | bulldog | 7/8" (22 mm) | yellow | 9-1/4" (235 mm) | 16 ga. | 13.9 |

Replacement springs for aviation snips

- P406 replacement spring for Cat. Nos. 1100L and 1102S
- P407 replacement spring for Cat. No. 1101R

All dimensions are in inches and (millimeters).

⚠WARNING: Always wear approved eye protection.

⚠WARNING: Never use on or near live electrical circuits

⚠WARNING: NOT insulated. Will NOT protect against electrical shock.



Cutting & Notching Tools

Snap Lock Punch



86560

- Compound-leverage mechanism for greater control and easy operation.
- Drop-forged, steel jaw easily punches 3/8" (9.5 mm) wide impressions on metal edges to easily join pieces of sheet metal, duct, or pipe.
- All-steel construction and nickel-chrome plated hardware provide long life and durability.
- Vinyl grips with handle stops for added comfort and easy operation.

| Cat. No. | Overall Length | Handle Color | Weight (lbs.) |
|----------|----------------|--------------|---------------|
| 86560 | 8" (203 mm) | blue | 1.0 |

Hand Notcher



86551

- Allows quick, clean, 30° "V" shaped cuts in sheet metal.
- Drop-forged, high-impact steel jaw with 13/16" (21 mm) maximum throat depth.
- Jaws' hook design allows easy notching of corners and take-off tabs without slippage.
- All steel construction with nickel-plate and black-oxide finish provides long life and durability.
- Hardened steel handles include hand guards and are covered with vinyl grips for added comfort and easy operation.

| Cat. No. | Overall Length | Handle Color | Weight (lbs.) |
|----------|-----------------|--------------|---------------|
| 86551 | 8-1/2" (216 mm) | blue | 1.0 |

Lightweight Tinner Snips



3100

- 6° angled, hollow-ground cutting edge for cutting full 3-1/2" (89 mm) straight cuts and wide curves.
- Easily replaceable cutting blades made of high-carbon steel.
- Cutting capacity: 22 gauge cold-rolled sheet metal; 26 gauge stainless steel sheet metal. Do not use to cut hardened wire, nails, or any other rounded surface.
- Lightweight magnesium handles.

| Cat. No. | Overall Length | Handle Color | Weight (oz.) |
|----------|----------------|--------------|--------------|
| 3100 | 13" (330 mm) | gray | 13.4 |

Replacement Parts

| | |
|------|--------------------------------------|
| 3101 | replacement blades for Cat. No. 3100 |
|------|--------------------------------------|

Nibbler Tool

- Cuts soft sheet metal, plastic, soft copper and aluminum, and tubing.
- Ideal for air conditioning and heating installation, automobile work, model making, and sheet metal construction.



76011B

- 1/4" cutting kerf.

| Cat. No. | Description | Cuts Up to | Weight (oz.) |
|----------|---------------------------|--|--------------|
| 76011B | nibbler cutter with blade | 18 gauge soft sheet metal, soft copper and aluminum up to 1/16", and tubing from a 1" I.D. | 5.6 |

Replacement Parts

| | |
|--------|---------------------------------------|
| 76012B | replacement blade for Cat. No. 76011B |
|--------|---------------------------------------|

Seaming & Folding Tools

Seamers – Straight and Offset

- Compound-leverage mechanism easily and accurately bends, seams, and flattens sheet metal and non-ferrous metals.
- Jaw marked in 1/4" (6 mm) increments for precise bending measurements.
- All-steel construction and nickel-chrome plated hardware provide long life and durability.
- Vinyl grips with handle stops for added comfort and easy operation.
- Straight-handle model is used for most general applications.
- Offset-handle model (not pictured) is for use in overhead or confined areas.
- Broader jaw model for forming wider folds.
- Folds 22 gauge CRSM and 24 gauge SSSM.

| Cat. No. | Type | Jaw Size | Overall Length | Handle Color | Weight (lbs.) |
|----------|----------------------|----------|-----------------|--------------|---------------|
| 86553 | straight-hand seamer | 3" | 8-3/8" (213 mm) | blue | 1.45 |
| 86552 | offset-hand seamer | 3" | 8" (203 mm) | blue | 1.46 |
| 86556 | straight-hand seamer | 6" | 8-3/8" (213 mm) | blue | 1.87 |



86556

All dimensions are in inches and (millimeters).

WARNING: Always wear approved eye protection.

WARNING: Never use on or near live electrical circuits.



Seaming & Folding Tools

Seamer Tongs, Straight and Offset

- Hot-drop forged for strength.
- Bending depth indicators marked in 1/4" (6 mm) increments.
- Cushioned handles.
- Offset-handle model for greater power and easy use in overhead and confined areas.

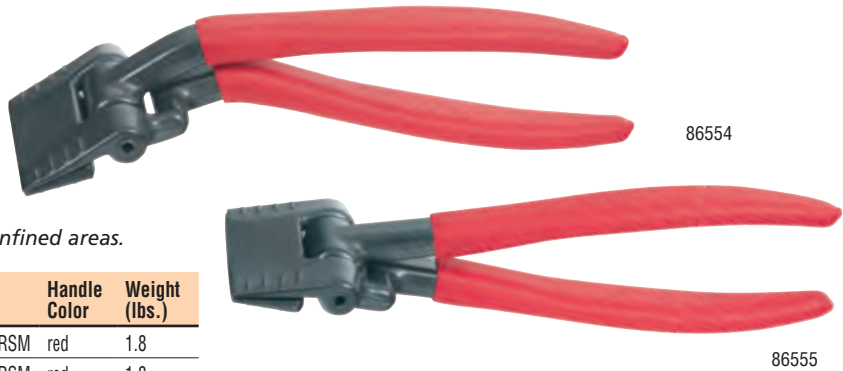

| Cat. No. | Type | Jaw Size | Overall Length | Bends | Handle Color | Weight (lbs.) |
|----------|----------|----------|-----------------|-------------|--------------|---------------|
| 86554 | offset | 3" | 9-3/4" (248 mm) | 22 ga. CRSM | red | 1.8 |
| 86555 | straight | 3" | 9-3/4" (248 mm) | 22 ga. CRSM | red | 1.8 |

Tube Benders

Swivel Handle Tube Bender

- Swivel handle repositions midway through bend to gain control, reduce efforts, and prevent handles from crossing.
- Easily fabricates bends up to 180°.
- Calibrated to show angle of bend.



| Cat. No. | Closed Overall Length | Tube O.D. | Weight (lbs.) |
|----------|-----------------------|-----------|---------------|
| 8900-1/4 | 10" (254 mm) | 1/4" | 1.0 |
| 8900-3/8 | 14-1/4" (362 mm) | 3/8" | 1.75 |
| 8900-1/2 | 21-7/8" (556 mm) | 1/2" | 3.50 |

8900-1/2

Professional 4-in-1 Tube Bender



89030

- Bends four popular tube sizes.
- Calibrated markings for accurate left-hand, right-hand, and offset bends up to 90°.
- For soft copper, aluminum, and steel tubing.
- Bends 3/16", 1/4", 5/16" and 3/8" (6 mm and 8 mm) O.D. tubing.

| Cat. No. | Closed Overall Length | Weight (lbs.) |
|----------|-----------------------|---------------|
| 89030 | 10" (254 mm) | 1.0 |

Folding Tools



88980

- Two folding depths: 3/8" (10 mm) and 1" (25 mm).
- Handy sight gauges for accurate depth alignment.
- Made of heavy-duty 16 gauge steel for folding strength.

| Cat. No. | Overall Length | Folds | Weight (lbs.) |
|----------|----------------|-----------------------------|---------------|
| 88980 | 12" (305 mm) | 24 ga. CRSM and 28 ga. SSSM | 1.3 |
| 88981 | 18" (457 mm) | 24 ga. CRSM and 28 ga. SSSM | 2.0 |
| 88982 | 24" (610 mm) | 24 ga. CRSM and 28 ga. SSSM | 2.6 |

Spring Type Tube Bender Sets

- 8-Pc. Set: Bends 1/4" to 7/8" O.D. tubing.
3-Pc. Set: Bends 1/4" to 3/8" O.D. tubing.
- Easily allows hand bending of soft copper and aluminum tubing into any shape without collapsing walls.
- Belled end for quick tube removal.

| Cat. No. | Type | Overall Length | Weight (oz.) |
|----------|-----------|-----------------------------|--------------|
| 89018 | 8 pc. set | 10" (254 mm) - 12" (305 mm) | 50.75 |
| 89019 | 3 pc. set | 10" (254 mm) | 10 |

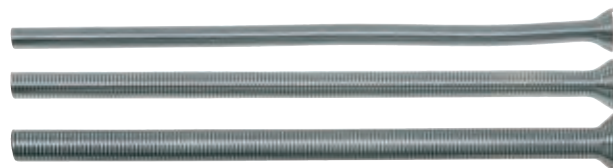

89019

All dimensions are in inches and (millimeters).

⚠WARNING: Always wear approved eye protection.

⚠WARNING: Never use on or near live electrical circuits.



Tube Cutters

Professional Tube Cutter



88904

- Accurate 4 roller tracking system – no spiraling.
- Professional reaming tool.
- Extra cutting wheel included in handle.

| Cat. No. | Cuts | Weight (lbs.) |
|--------------------------|---------------------------------------|---------------|
| 88904 | 1/8" – 1-1/8" steel and copper tubing | 1.31 |
| Replacement Parts | | |
| 88905 | replacement wheel for Cat. No. 88904 | .08 |

Professional Tube Cutter



88975



88976

- Smooth feed mechanism for precise, right angle cutting action.
- Includes retractable reamer with filing surface and spare cutter wheel.
- Not designed for cutting stainless steel or hard tempered tubing.

| Cat. No. | Overall Length | Cuts | Weight (oz.) |
|--------------------------|---|---------------------------|--------------|
| 88975 | 5" (127 mm) | 1/8" - 1-1/8" O.D. tubing | 6.5 |
| Replacement Parts | | | |
| 88976 | replacement wheels + screw for Cat. No. 88975 | | |

Swaging Tool – Punch Type

Professional 6-in-1 Swaging Punch



66400

- Swages six sizes of tubing.
- Hex design for ease of extraction.
- Precision machined surface for ease of forming.
- High-alloy steel, heat-treated for strength and durability.

| Cat. No. | Overall Length | Swages | Weight (oz.) |
|----------|------------------|---|--------------|
| 66400 | 5-3/16" (132 mm) | 3/16", 1/4", 5/16", 3/8" 1/2", 5/8" O.D. tubing | 5.92 |

Professional Mini Tube Cutter



88977



88978

- Perfect for tight space cutting. Requires only 1-3/8" swing radius.
- Smooth feed mechanism for precise, right angle cutting action.
- Not designed for cutting stainless steel or hard tempered tubing.

| Cat. No. | Overall Length | Cuts | Weight (oz.) |
|--------------------------|---|-----------------------|--------------|
| 88977 | 1-3/4" (44 mm) | 1/8"-5/8" O.D. tubing | 2.5 |
| Replacement Parts | | | |
| 88978 | replacement wheels + screw for Cat. No. 88977 | | |

Tube Cutter Accessories

Inner-Outer Reaming and Deburring Tool

- Reams inside and outside edges of tubing.
- Deburrs with clockwise and counter-clockwise rotations.
- Reams copper, aluminum, and brass tubing.



89025

| Cat. No. | Overall Length | Color | Reams | Weight (oz.) |
|----------|----------------|--------|-----------------------------|--------------|
| 89025 | 2-1/4" (57 mm) | yellow | 3/16" to 1-1/2" O.D. tubing | 10.08 |

Tube Flaring & Swaging Tools

45° Flaring and Swaging Tool Sets



89020

Includes case

- Converts from flares to swages with easy screw-on application.
- Self-centering, slip-on forged steel yoke easily forms quality flares/swages.
- Flares 1/8", 3/16", 1/4", 5/16", 3/8", 7/16", 1/2", 5/8" and 3/4" O.D.
- Swages 3/16", 1/4", 5/16", 3/8", 1/2", 5/8" and 3/4" O.D. tubing.
- Cat. No. 89021 Flares 3/16", 1/4", 5/16", 3/8", 7/16", 1/2" and 5/8" O.D. tubing.

| Cat. No. | Dimensions | Weight |
|----------|---|-----------|
| 89020 | 6-1/8" L (157 mm) x 6-1/2" W (165 mm) x 4-13/32" H (112 mm) | 4.71 lbs. |
| 89021 | 7" (178 mm) L x 4-13/16" W (122 mm) x 3-9/32" H (236 mm) | 2.0 lbs. |

All dimensions are in inches and (millimeters).

WARNING: Always wear approved eye protection.

WARNING: Never use on or near live electrical circuits.



Duct Stretching & Slitting Tools

Duct Stretcher



89565

- Aligns and pulls ductwork together, easing installation of drive cleats.
- Offset handle protects hand.

| Cat. No. | Overall Length | Weight (oz.) |
|----------|----------------|--------------|
| 89565 | 16" (406 mm) | 12 |

Duct Slitting Tool



DS7

- Blade used to scribe a line or pierce and enlarge holes in sheet metal.
- Cushion-Grip handle for greater comfort and control.
- Patented Tip-Ident® quickly identifies the type of tool and tip orientation.

| Cat. No. | Overall Length | Weight (oz.) |
|----------|------------------|--------------|
| DS7 | 12-5/8" (321 mm) | 5.6 |

Crimping Tools

5-Blade Crimper



86550

- Produces factory-precision indentations in stove pipe and round duct with just a squeeze.
- Compound-leverage mechanism, heavy-duty jaw/handle linkage, and closing stop provide easy operation and consistent crimps for virtually leak-proof connections.
- Hardened steel handles include hand guards and are covered with vinyl grips for added comfort and easy operation.
- All steel construction and nickel-plating provide long life and consistent crimp profile.

| Cat. No. | Overall Length | Crimps | Handle Color | Weight (lbs.) |
|----------|----------------|-----------------------------|--------------|---------------|
| 86550 | 9" (229 mm) | 24 ga. CRSM and 28 ga. SSSM | blue | 1.00 |

Sheet Metal Fasteners

Self-Piercing Sheet Metal Screws



8910-3/4

- Zinc plated.
- Sheet metal screws with self piercing tips.
- Slotted 1/4" hex head washer.

| Cat. No. | Length | Driver Type | Size | Qty | Head Type |
|----------|--------------|--------------|------|------|------------|
| 8910-3/4 | 3/4" (19 mm) | 1/4" slotted | #8 | 1000 | hex washer |
| 8910-1/2 | 1/2" (13 mm) | 1/4" slotted | #8 | 1000 | hex washer |

Magnetic Hex Drivers

Magnetic Hex Drivers

- For driving sheet metal screws.
- Strong Rare Earth magnets for maximum holding.
- 1/4" hex shank with quick release groove.



86602

| Cat. No. | Description | Weight (lbs.) |
|---|------------------------------------|---------------|
| 86600 | 1/4" magnetic hex driver – 3 pack | .12 |
| 86601 | 5/16" magnetic hex driver – 3 pack | .14 |
| 86602 | 3/8" magnetic hex driver – 3 pack | .16 |
| 10-Pack Punch Card for Individual Sale | | |
| 86600-10 | 1/4" magnetic hex driver | .43 |
| 86601-10 | 5/16" magnetic hex driver | .49 |
| 86602-10 | 3/8" magnetic hex driver | .57 |

All dimensions are in inches and (millimeters).

⚠ WARNING: Always wear approved eye protection.

⚠ WARNING: Never use on or near live electrical circuits.



Refrigeration Wrenches

Ratcheting Refrigeration Wrenches

- Fully reversible ratchet wrenches designed for refrigeration packing gland nuts and valve stem sockets.
- Also designed for beam-clamp installation.
- Wrenches are compact in size, with clearly marked sockets for four nut sizes.
- Quick-flip reversing lever permits instant ratchet reversal.
- Wrenches are ruggedly built and have polished chrome finish with smooth edges for comfort.



68310

| Cat. No. | Socket Sizes | Length | Weight (lbs.) |
|----------|---|-------------------|---------------|
| 68309 | 3/16" and 1/4" sq. x 1/2" and 9/16" hex | 6-13/16" (173 mm) | .43 |
| 68310 | 3/16" and 5/16" sq. x 1/4" and 3/8" sq. | 5-1/2" (140 mm) | .20 |
| 68310-24 | 24 pack of Cat. No. 68310 | 5-1/2" (140 mm) | 4.70 |

Nylon Tie Tensioning Tools

Nylon Tie Tensioning Tools

- Designed for work with ties rated at 120 - 250 lbs. (54 - 113 kg).
- Tensions up to 65 lbs. of force (30 kg).
- Maximum tie width of 15/32" (12 mm).
- Handle grips for comfort.
- Excess tie material is automatically cut off (Cat. No. 86571 only).



86571



86570

| Cat. No. | Description | Weight (lbs.) |
|----------|---------------------------------------|---------------|
| 86570 | nylon tie tensioning tool – manual | 0.87 |
| 86571 | nylon tie tensioning tool – automatic | 1.01 |

Special-Purpose Knives

Serrated Duct Knife

- Cuts duct board and flexible duct.
- Double-edged knife – regular and serrated.
- Cushion-grip handle for comfort.
- Includes puncture resistant nylon sheath with belt loop.



DK06



| Cat. No. | Blade Steel | Blade Length | Weight (lbs.) |
|----------|-----------------|---------------|---------------|
| DK06 | stainless steel | 5.5" (140 mm) | 0.53 |

Specialty Screwdrivers

11-in-1 Screwdriver/Nut Driver with Schrader® Valve Removal/Installation Bit

Additional Features:

- Versatile 11-in-1 tool for the professional.
- Includes unique style bit for installation/removal of common TR-4 Schrader® valves and aggressive thread extractor tip for backing out broken cores.
- Great for HVAC and other industrial applications.
- Cushion-Grip handle for greater torque and comfort.
- Blast finish bit tips provide a firm hold and reduce cam out.



32527

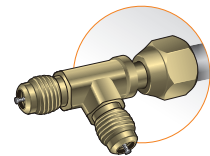

Schrader® is a registered trademark of Schrader International, Inc.

| Cat. No. | Contains | Weight (lbs.) |
|----------|--|---------------|
| 32527 | 3/8", 5/16" and 1/4" nut drivers, #1 and #2 Phillips, #1 square and #2 square, 1/4" and 3/16" slotted, Schrader® valve core removal/installation – extractor | .44 |

All dimensions are in inches and (millimeters).

▲WARNING: Always wear approved eye protection.

▲WARNING: Never use on or near live electrical circuits.



Setting Hammer



820-16

- Durable epoxy resin handle helps to protect neck from fraying and splintering if incorrectly struck or over struck.
- High-strength fiberglass shaft absorbs shock and keeps head tight.
- Cushioned, PVC grip bonded to handle.
- Special high-carbon steel, octagon shaped head with flat striking surface and rounded cross peen.

| Cat. No. | Head Weight | Overall Length | Weight (lbs.) |
|----------|----------------|----------------|---------------|
| 820-16 | 16 oz. (454 g) | 13" (330 mm) | 1.6 |

Riveting Hammer



821-12

- High-carbon steel round head is forged and hardened.
- Flat striking surface with rounded cross peen.
- Straight-grain American hickory handle is stained and lacquered.

| Cat. No. | Head Weight | Overall Length | Weight (lbs.) |
|----------|----------------|------------------|---------------|
| 821-12 | 12 oz. (340 g) | 12-1/4" (311 mm) | 1.1 |

Dead Blow Hammers

NEW!



811-16

- Non-marring. Less rebound than regular hammers.
- 40% more driving power than other dead blow hammers.
- Increased surface protection.
- Applications: HVAC, metal fabrication, electronics, oil and mining, wood and metal assembly, automotive, aerospace.

| Cat. No. | Head Weight | Overall Length | Weight (lbs.) |
|----------|----------------|----------------|---------------|
| 811-16 | 16 oz. (454 g) | 12.5" (318 mm) | 1.44 |
| 811-32 | 32 oz. (908 g) | 18" (457 mm) | 1.8 |



All dimensions are in inches and (millimeters).

⚠WARNING: Always wear approved eye protection.