

SEIC113 - STEP LIGHT HOUSING

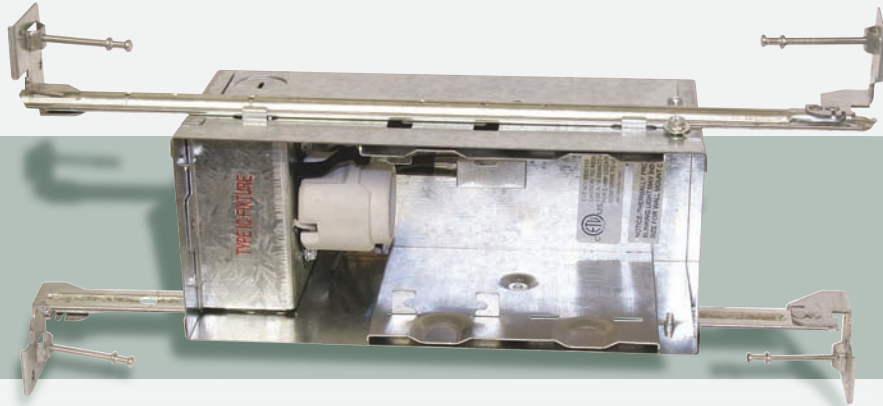

- Step Light housing for incandescent lamp.
- For use indoors in insulated (IC) and Non-insulated (NON-IC) areas.
- For damp location only.
- Conforms to UL standard 1598.

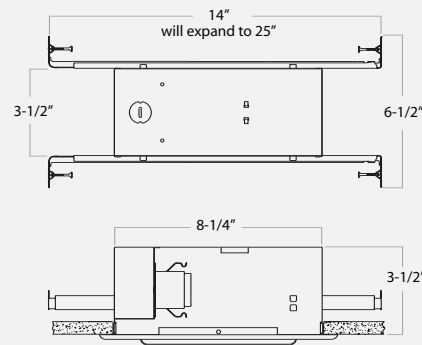

STEP LIGHT TRIMS (FOR USE WITH SEIC113 HOUSING)



- Secure trim retention w/ torsion springs.

SE104-WH

Diffuse Glass Lens w/ White Trim

Max. lamp rating: Non-IC 40W A19 / IC 25W A19

Trim size: L=9-1/2" X H=4-7/8"

FINISH:

WH-White BR-Bronze SN- Satin Nickel



- Secure trim retention w/ torsion springs.

SE840-WH

Angled Louvers w/ White Trim

Max. lamp rating: Non-IC 40W A19 / IC 25W A19

Trim size: L=9-1/2" X H=4-7/8"

FINISH:

WH-White BR-Bronze SN- Satin Nickel