

Calbrite™

STAINLESS STEEL CONDUIT SYSTEMS

For Petroleum & Chemical Industries

Corrosion Resistant

Lowest Cost of Ownership

Ease of Installation

No Special Tools

Broadest Product Offering



2011

www.calbrite.com

THE CALBRITE™ DIFFERENCE

OUR HISTORY

The Calbrite™ heritage dates back to 1917 with the founding of Jackson-Markus Supply by Peter Markus, the grandfather of Dan Markus, president of Calpipe Industries, the parent company of Calbrite. Jackson-Markus Supply manufactured and distributed flow control products, plumbing fittings and construction materials. In the early 1960s, the family expanded into stainless steel and nickel alloy weld fittings, servicing a rapidly-growing market in refining, petrochemical, food processing, breweries, marine and other industries. Recognizing the similarities between the plumbing, PVF and electrical industries, Dan Markus founded Calpipe Industries in 1986 to focus on the electrical industry. Today, Calpipe Industries manufactures and distributes electrical conduit and fittings under the brand names of Calconduit and Calbrite. The company also expanded into security bollards, marketed through Calpipe Security Bollards.

Headquartered in Hammond, IN, Calbrite is the leading name in stainless steel conduit systems for harsh and corrosive environments. We offer the largest stainless steel conduit systems product line in the industry, manufactured to strict guidelines set forth by UL and NEMA, and many of our products are ARRA-compliant.

Calbrite supports our customers through:

- The industry's broadest and deepest product offering. We currently offer more than 2800 SKUs, ensuring you that we can support just about any customer's stainless conduit system need.
- A customer-centric product development process. Simply put, we listen to our customers and quickly deliver solutions designed to meet their needs.
- For example, our new in-use box was developed for a large food-processing manufacturer that had requested a hinged single gang box cover in stainless steel that was both lockable and weatherproof for wash-down environments. We are known for developing products for customers to address their specific needs, and then offering the solution to the industry.
- A national network of independent sales agents across North America. To find the rep nearest you, visit www.calbrite.com/replist.
- Manufacturing and distribution centers in Hammond, IN; Downey, CA and Odessa, FL to service our distributors and their customers throughout the U.S. and Canada.

OUR COMMITMENT

At Calbrite, we are dedicated to providing our customers with quality stainless steel conduit and fittings, delivered on a timely basis, that consistently meet expectations and industry standards.

OUR QUALITY ASSURANCE

Our quality assurance program complies with industry standards established by Underwriters' Laboratories (UL), ANSI, and NEMA.

UL listings: 

- Our approval file number for ferrous electrical conduit is E226472.
- Our approval file number for non-ferrous electrical conduit is E230584 (issue #26KT)

Many of our products are produced to NEMA 4X standards, which ensure protection against corrosion, wind-blown dust and rain, splashing water, hose-directed water and damage from external ice formation in outdoor or indoor environments.



TABLE OF CONTENTS

STAINLESS STEEL CONDUIT, ELBOWS AND NIPPLES

Conduit	5
Nipples	5
Light Wall Conduit	6
EMT Conduit	6
Elbows	7
EMT Elbows	7

STAINLESS STEEL CONDUIT FITTINGS

Compression Fittings	8
EMT Compression Fittings	8
Flex Conduit	9
Flexible Connectors	9
3-Piece Couplings	10
Couplings	10
Line Terminator Hubs	10
Grounding Hubs	10
Conduit Bodies – Form 8 Style	11

CALSTRUT™ STAINLESS STEEL STRUT

Slotted Strut	12
Solid Strut	12
Back-to-Back Strut	12
Strut Post Base	12
Post Base for Channel	12

STAINLESS STEEL STRUT ACCESSORIES

4-Hole Flat Angle Plate	13
4-Hole Splice Plate	13
3-Hole Flat Angle Plate	13
Cross Plate	13
Tee Plate	13
4-Hole Angle Bracket	13
2-Hole Angle Bracket	13
Saddle Washers	13
Channel Nuts with Spring	13
U-Fitting	13

STAINLESS STEEL CORD GRIP CONNECTORS

Cord Grip Connectors	14
Cord Grip Connectors with Mesh	15

STAINLESS STEEL DEVICE BOXES

FS Single Gang Box	16
FDC Single Gang Box	16
FDCC & FSCC Single Gang Boxes	16
FSCT & FDCT Single Gang Boxes	16
FD Single Gang Box	16
FDC Double Gang Box	16
FDX & FSX Single Gang Boxes	16
IN-USE Boxes	16
Device Box Covers	16
Device Box Plates	16

STAINLESS STEEL ACCESSORIES

Locknuts	17
Standard Washers	17
Lock Washers	17
Grounding Locknuts	17
Hex Nuts	17
Square Washers	17
Threaded Rod	17
Hex Head Cap Screws	17
Slotted Machine Screws	17
Split Ring Clamps	18
Split Ring Extensions	18
Split Ring Mounting Plates	18
Conduit Hangers	18
Parallel Clamps	18
Strut Clamps	18
Right Angle Clamps	18
Right Angle Beam Clamps	18
Beam Clamps	18
2-Hole Straps	18
1-Hole Straps	18

MISCELLANEOUS

Counter Sunk Hex Plugs	19
Threaded Conduit Caps	19
Conduit Body Cover, Gasket, & Screw Sets	19
Face Bushings	19
Box Connectors	19
Rod Couplings	19
Standard U-Bolts	19
Pulling Elbows	19

THE BENEFITS OF STAINLESS STEEL

CORROSION IS COSTLY.

Stainless steel is the highest quality, most durable, easiest to install, UL-approved conduit material available. Corrosion damages equipment which results in downtime and expensive maintenance and repairs. Stainless conduit systems, designed for harsh environments, are the material of choice due to:

- Corrosion-resistance. Both 304 and 316 stainless steel alloys provide excellent resistance to a wide range of corrosives, at extreme temperatures and in most industrial environments. When scratched, stainless steel's exposed metal "self-heals", oxidizing over the abrasion to protect against further corrosion.
- Longevity. Stainless steel conduit's durability, sometimes up to 50 years, reduces the need for costly maintenance or replacement needs, providing long-term protection of your facility and improving your equipment investment.
- Lowest total cost of ownership. In many applications, stainless steel has a lower maintenance cost and the lowest total life cycle cost than any other UL-approved conduit material. Coupled with stainless' longevity, facility downtime due to conduit replacement is minimized.
- Environmentally-friendly. Stainless steel retains structural and anti-corrosive properties in temperatures ranging from cryogenic to hundreds of degrees and does not burn and emit dangerous smoke and carcinogens. Additionally, stainless steel can be recycled.
- Ease of installation. Calbrite™ stainless steel conduit and fittings do not require installers to use special tools or labor-intensive procedures for installation. And stainless is in full NEC compliance for all facilities.

WHAT DOES THIS MEAN TO YOU?

Stainless steel provides a reliable, durable conduit that ensures uptime, increases productivity, and provides a long service life in industrial and commercial applications. In short, stainless steel offers a significant cost savings over alternative conduit and fittings. This is why stainless is the first choice for applications in hospitals, kitchens, clean rooms, potable water or beverage & food processing plants, petrochemical & refining facilities, pulp & paper production, wastewater treatment plants, mining, and other facilities with stringent requirements.

WHY CALBRITE™

Calbrite is the leading name in stainless steel conduit systems. We offer the largest stainless steel conduit systems product line in the industry, manufactured to strict guidelines set forth by UL and NEMA, and many of our products are ARRA-compliant. Calbrite supports its customers throughout the US and Canada from three distribution centers in the US. Calbrite is committed to providing quality products, the fastest delivery possible, and friendly, personal, and reliable service to our customers.

CALBRITE™ STAINLESS STEEL VS. ALUMINUM?

- Stainless steel conduit and fittings have up to five times the strength of aluminum and will last several times longer.
- Stainless steel holds up against the same wash-down procedures and products that all installed stainless steel processing equipment stands up to whereas aluminum cannot.

CALBRITE™ STAINLESS STEEL VS. PVC-COATED?

PVC Coated:

- Requires special installation tools, unlike stainless steel
- Toxicity may make it undesirable for food & potable water
- Potential "frequent" repairs
- If damaged, causes galvanized conduit to be exposed directly to corrosive environment
- Is not considered to be recyclable – stainless steel is 100% recyclable

To learn more, or to get fast, reliable service and quality stainless steel conduit and fittings at competitive prices please contact us.

DIVISIONS OF CALPIPE INDUSTRIES

Calbrite (Midwest)

www.calbrite.com
(219) 844-6800
(800) 536-2248
(219) 844-6884 fax

Calconduit (West Coast)

www.calconduit.com
(562) 803-4388
(800) 225-7473
(562) 803-9883 fax

Calpipe Security Bollards (West Coast)

www.calpipebollards.com
(562) 803-4388
(877) 283-8518
(562) 803-9985 fax

STAINLESS STEEL CONDUIT

Trade Size	Metric Size	Diameters		Wt./Ft.	10' Length w/ Coupling		5' Length w/ Coupling	
		OD	ID		Type 304	Type 316	Type 304	Type 316
1/2"	16	0.840"	0.620"	0.82	S40510CT00	S60510CT00	S40505CT00	S60505CT00
3/4"	21	1.050"	0.824"	1.09	S40710CT00	S60710CT00	S40705CT00	S60705CT00
1"	27	1.315"	1.049"	1.61	S41010CT00	S61010CT00	S41005CT00	S61005CT00
1-1/4"	35	1.660"	1.380"	2.18	S41210CT00	S61210CT00	S41205CT00	S61205CT00
1-1/2"	41	1.900"	1.610"	2.63	S41510CT00	S61510CT00	S41505CT00	S61505CT00
2"	53	2.375"	2.067"	3.5	S42010CT00	S62010CT00	S42005CT00	S62005CT00
2-1/2"	63	2.875"	2.469"	5.59	S42510CT00	S62510CT00	S42505CT00	S62505CT00
3"	78	3.500"	3.068"	7.27	S43010CT00	S63010CT00	S43005CT00	S63005CT00
4"	103	4.500"	4.026"	10.08	S44010CT00	S64010CT00	S44005CT00	S64005CT00

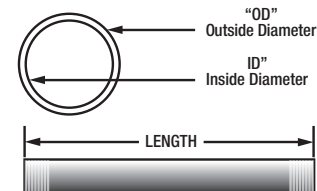

Calbrite™ stainless steel rigid conduit is manufactured in type 304 & 316 stainless to meet stringent sanitary requirements and withstand harsh corrosive environments. The conduit is polished to a bright, easily maintainable finish that allows for minimal cleaning, enhances the appearance, and improves the surface's resistance to pitting & bacterial corrosion in CIP (clean-in-place) and SIP (sterilize-in-place) systems.

Calbrite stainless steel rigid conduit is highly resistant to damage from impact. Easy to cut, form and join, stainless steel conduit avoids the labor-intensive procedures that come with PVC-coated installation. No special tools or complicated maintenance and repair procedures are required. In addition to the ease of installation and maintenance, stainless steel is 100% recyclable. Standard rigid conduit threads allow for trouble-free installations.

* Trade sizes 1/2" to 4"

* Includes one coupling with each length purchased

* Custom lengths and diameters are available

* Conduit is domestically manufactured in our U.S. manufacturing facilities

Compliances: Underwriter Laboratories Listed for

US and Canada standard UL6A File # E230584

American National Standards Institute (ANSI) specification C80.1

STAINLESS STEEL NIPPLES Custom lengths available upon request



Type 304 SS 		1-1/2"	2"	2-1/2"	3"	3-1/2"	4"	5"	6"
Trade Size	Close								
1/2"	S405CLCN00	S40515CN00	S40520CN00	S40525CN00	S40530CN00	S40535CN00	S40540CN00	S40550CN00	S40560CN00
3/4"	S407CLCN00	S40715CN00	S40720CN00	S40725CN00	S40730CN00	S40735CN00	S40740CN00	S40750CN00	S40760CN00
1"	S410CLCN00		S41020CN00	S41025CN00	S41030CN00	S41035CN00	S41040CN00	S41050CN00	S41060CN00
1-1/4"	S412CLCN00		S41220CN00	S41225CN00	S41230CN00	S41235CN00	S41240CN00	S41250CN00	S41260CN00
1-1/2"	S415CLCN00		S41520CN00	S41525CN00	S41530CN00	S41535CN00	S41540CN00	S41550CN00	S41560CN00
2"	S420CLCN00			S42025CN00	S42030CN00	S42035CN00	S42040CN00	S42050CN00	S42060CN00
2-1/2"	S425CLCN00				S42530CN00	S42535CN00	S42540CN00	S42550CN00	S42560CN00
3"	S430CLCN00				S43030CN00	S43035CN00	S43040CN00	S43050CN00	S43060CN00
4"	S440CLCN00					S44035CN00	S44040CN00	S44050CN00	S44060CN00

Type 316 SS 		1-1/2"	2"	2-1/2"	3"	3-1/2"	4"	5"	6"
Trade Size	Close								
1/2"	S605CLCN00	S60515CN00	S60520CN00	S60525CN00	S60530CN00	S60535CN00	S60540CN00	S60550CN00	S60560CN00
3/4"	S607CLCN00	S60715CN00	S60720CN00	S60725CN00	S60730CN00	S60735CN00	S60740CN00	S60750CN00	S60760CN00
1"	S610CLCN00		S61020CN00	S61025CN00	S61030CN00	S61035CN00	S61040CN00	S61050CN00	S61060CN00
1-1/4"	S612CLCN00		S61220CN00	S61225CN00	S61230CN00	S61235CN00	S61240CN00	S61250CN00	S61260CN00
1-1/2"	S615CLCN00		S61520CN00	S61525CN00	S61530CN00	S61535CN00	S61540CN00	S61550CN00	S61560CN00
2"	S620CLCN00			S62025CN00	S62030CN00	S62035CN00	S62040CN00	S62050CN00	S62060CN00
2-1/2"	S625CLCN00				S62530CN00	S62535CN00	S62540CN00	S62550CN00	S62560CN00
3"	S630CLCN00				S63030CN00	S63035CN00	S63040CN00	S63050CN00	S63060CN00
4"	S640CLCN00					S64035CN00	S64040CN00	S64050CN00	S64060CN00

STAINLESS STEEL LIGHT WALL CONDUIT

Light Wall Conduit						
Trade Size	Metric Size	Outside Dia.	Inside Dia.	Wt./Ft.	Type 304	Type 316
½"	16	0.840"	0.670"	0.67	S50510CT00	S70510CT00
¾"	21	1.050"	0.884"	0.86	S50710CT00	S70710CT00
1"	27	1.320"	1.097"	1.40	S51010CT00	S71010CT00
1-½"	41	1.900"	1.682"	2.09	S51510CT00	S71510CT00
2"	53	2.380"	2.157"	2.64	S52010CT00	S72010CT00

Calbrite™ stainless steel light wall conduit is equivalent to a non-threaded stainless IMC conduit. Calbrite light wall conduit is more impact resistant compared with EMT and is 100% recyclable. Stainless steel light wall is often specified in corrosive environments where it is subjected to harsh chemical treatments or wash-downs due to its lighter weight, precise tolerances, and ease of installation.

Light wall conduit is manufactured without threads, and is joined together by utilizing compression fittings simplifying installations and lowering costs. Light wall conduit is easily cut and bent using standard tools.

- * Custom lengths are available
- * Trade sizes ½", ¾", 1", 1-1/2", 2"

Compliances: Manufactured to the highest standards of the American National Standards Institute (ANSI) and Underwriters Laboratories (UL).

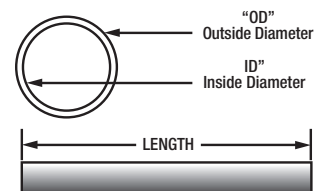

STAINLESS STEEL EMT CONDUIT

EMT Conduit								
Nominal Size		Diameters		Wt./Ft.	10' Length	10' Length	5' Length	5' Length
Trade Size	Metric Size	O.D.	I.D.		Type 304	Type 316	Type 304	Type 316
½"	16	0.710"	0.622"	0.30	S10510CT00	S20510CT00	S10505CT00	S20505CT00
¾"	21	0.930"	0.824"	0.46	S10710CT00	S20710CT00	S10705CT00	S20705CT00
1"	27	1.170"	1.050"	0.67	S11010CT00	S21010CT00	S11005CT00	S21005CT00
1-¼"	35	1.510"	1.380"	1.01	S11210CT00		S11205CT00	
1-½"	41	1.740"	1.610"	1.16	S11510CT00		S11505CT00	
2"	53	2.200"	2.067"	1.48	S12010CT00		S12005CT00	

Calbrite stainless steel EMT conduit and fittings combine strength with ductility, resulting in a lightweight and easy-to-handle conduit assembly. EMT can be installed indoors and outdoors in accordance with NEC®, providing it will not be subject to severe physical damage during and after installation.

Calbrite stainless steel EMT provides superior performance in applications subject to corrosive environments, harsh chemical treatments, and required wash-downs. In addition to the ease of installation and maintenance, stainless steel is 100% recyclable. Calbrite EMT enhances the appearance and the surface's resistance to pitting & bacterial corrosion in CIP (clean-in-place) and SIP (sterilize-in-place) systems.

- * Trade sizes ½" – 2"
- * Conduit is domestically manufactured in our U.S. manufacturing facilities

Calbrite stainless steel EMT is manufactured to UL797 standards and meets ANSI C80.3

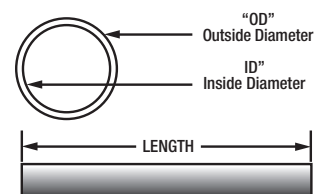

STAINLESS STEEL ELBOWS (Type 304 & 316)

Standard Radius Elbows 90°			c(UL)us				
Trade Size	Metric Size	Outside Dia.	Inside Dia.	A	B	Type 304	Type 316
½"	16	0.840"	0.620"	3.79"	4.25"	S40590EL00	S60590EL00
¾"	21	1.050"	0.824"	3.94"	4.50"	S40790EL00	S60790EL00
1"	27	1.315"	1.049"	5.05"	5.75"	S41090EL00	S61090EL00
1-¼"	35	1.660"	1.380"	6.38"	7.25"	S41290EL00	S61290EL00
1-½"	41	1.900"	1.610"	7.26"	8.25"	S41590EL00	S61590EL00
2"	53	2.375"	2.067"	8.27"	9.50"	S42090EL00	S62090EL00
2-½"	63	2.875"	2.469"	9.02"	10.50"	S42590EL00	S62590EL00
3"	78	3.500"	3.068"	11.21"	13.00"	S43090EL00	S63090EL00
4"	103	4.500"	4.026"	13.71"	16.00"	S44090EL00	S64090EL00

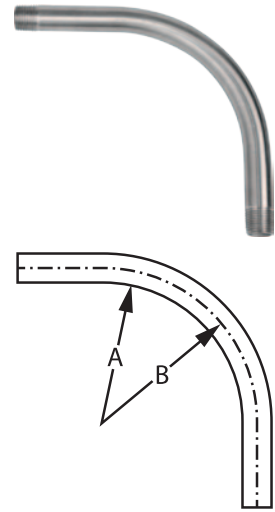

Standard Radius Elbows 45°			c(UL)us				
Trade Size	Metric Size	Outside Dia.	Inside Dia.	A	B	Type 304	Type 316
½"	16	0.840"	0.620"	3.79"	4.25"	S40545EL00	S60545EL00
¾"	21	1.050"	0.824"	3.94"	4.50"	S40745EL00	S60745EL00
1"	27	1.315"	1.049"	5.05"	5.75"	S41045EL00	S61045EL00
1-¼"	35	1.660"	1.380"	6.38"	7.25"	S41245EL00	S61245EL00
1-½"	41	1.900"	1.610"	7.26"	8.25"	S41545EL00	S61545EL00
2"	53	2.375"	2.067"	8.27"	9.50"	S42045EL00	S62045EL00
2-½"	63	2.875"	2.469"	9.02"	10.50"	S42545EL00	S62545EL00
3"	78	3.500"	3.068"	11.21"	13.00"	S43045EL00	S63045EL00
4"	103	4.500"	4.026"	13.71"	16.00"	S44045EL00	S64045EL00

* Large radius rigid stainless elbows are available upon request in 24", 36", 48" and 60"

STAINLESS STEEL EMT ELBOWS

Standard Radius Elbows 90°						
Trade Size	Outside Dia.	Inside Dia.	Min. Radius	Straight Leg Each End	Type 304	Type 316
½"	0.710"	0.622"	4"	2"	S10590EL00	S20590EL00
¾"	0.930"	0.824"	4-½"	2"	S10790EL00	S20790EL00
1"	1.170"	1.050"	5-¾"	2"	S11090EL00	S21090EL00

Standard Radius Elbows 45°						
Trade Size	Outside Dia.	Inside Dia.	Min. Radius	Straight Leg Each End	Type 304	Type 316
½"	0.710"	0.620"	4"	2"	S10545EL00	S20545EL00
¾"	0.930"	0.820"	4-½"	2"	S10745EL00	S20745EL00
1"	1.170"	1.050"	5-¾"	2"	S11045EL00	S21045EL00

* Light wall elbows are also available upon request

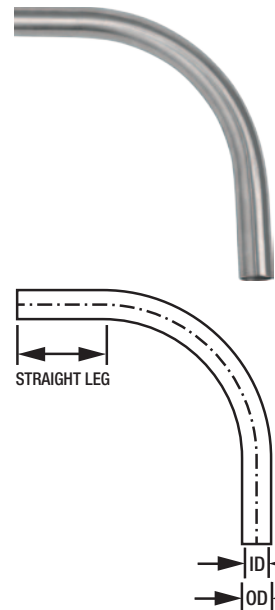

STAINLESS STEEL COMPRESSION FITTINGS (Type 316SS)

Male Compression Connectors			<i>NEMA4X</i>		
Trade Size	Metric Size	Wt. (lbs)	Part Number	A	B
½"	16	0.11	S60500MC00	1.670"	1.340"
¾"	21	0.16	S60700MC00	1.860"	1.615"
1"	27	0.23	S61000MC00	1.970"	2.000"
1-½"	41	0.33	S61500MC00	2.110"	2.550"
2"	53	0.45	S62000MC00	2.530"	3.110"

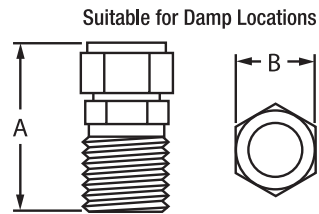

Compression Unions			<i>NEMA4X</i>		
Trade Size	Metric Size	Wt. (lbs)	Part Number	A	B
½"	16	0.28	S60500CC00	2.120"	1.340"
¾"	21	0.42	S60700CC00	2.220"	1.615"
1"	27	0.67	S61000CC00	2.400"	2.000"
1-½"	41	1.11	S61500CC00	2.670"	2.550"
2"	53	1.75	S62000CC00	2.880"	3.110"

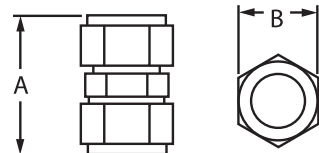

* Compatible for use with stainless steel light wall and rigid conduit

STAINLESS STEEL EMT COMPRESSION FITTINGS (Type 316SS)

EMT Male Compression Fittings			<i>NEMA4X</i>		
Trade Size	Metric Size	Wt. (lbs)	Part Number	A	B
½"	16	0.18	S20500MC00	1.600"	1.050"
¾"	21	0.28	S20700MC00	1.700"	1.290"
1"	27	0.43	S21000MC00	1.770"	1.580"
1-¼"	35	0.6	S21200MC00	1.850"	1.960"
1-½"	41	0.73	S21500MC00	2.080"	2.220"
2"	53	1.22	S22000MC00	2.130"	2.730"

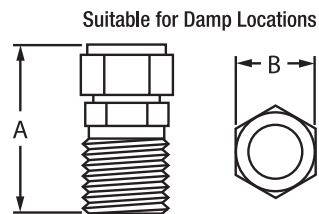

EMT Compression Unions			<i>NEMA4X</i>		
Trade Size	Metric Size	Wt. (lbs)	Part Number	A	B
½"	16	0.16	S20500CC00	2.060"	1.050"
¾"	21	0.21	S20700CC00	2.110"	1.290"
1"	27	0.31	S21000CC00	2.170"	1.580"
1-¼"	35	0.47	S21200CC00	2.530"	1.960"
1-½"	41	0.63	S21500CC00	2.740"	2.220"
2"	53	0.83	S22000CC00	2.930"	2.730"

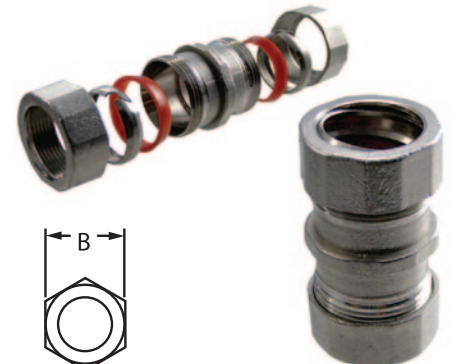
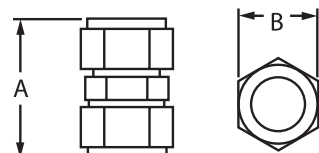

* Compatible for use with stainless steel EMT conduit

STAINLESS STEEL FLEXIBLE CONDUIT (Type 304SS)

Coated Flex Conduit 25' Length						<i>NEMA4X</i>
Nominal Size		Diameters			Suitable for damp locations	
Trade Size	Metric Size	O.D.	I.D.	Bend	Wt. 25' Coil	Part Number
½"	16	0.845"	0.610"	4-½"	5	S40500CTFC
¾"	21	1.050"	0.790"	6"	7.5	S40700CTFC
1"	27	1.300"	1.010"	10"	12	S41000CTFC
1-½"	41	1.860"	1.520"	12"	24	S41500CTFC



Clear Coated Flex Conduit 25' Length						<i>NEMA4X</i>
Nominal Size		Diameters			Suitable for damp locations	
Trade Size	Metric Size	O.D.	I.D.	Bend	Wt. 25' Coil	Part Number
½"	16	0.845"	0.610"	4-½"	5	S40500CTCC
¾"	21	1.050"	0.790"	6"	7.5	S40700CTCC
1"	27	1.300"	1.010"	10"	12	S41000CTCC
1-½"	41	1.860"	1.520"	12"	24	S41500CTCC



Flex Conduit 25' Length						
Nominal Size		Diameters				
Trade Size	Metric Size	O.D.	I.D.	Bend	Wt. 25' Coil	Part Number
½"	16	0.744"	0.610"	4"	4	S40500CTFX
¾"	21	0.960"	0.790"	4-½"	7	S40700CTFX
1"	27	1.160"	1.010"	6"	10	S41000CTFX
1-¼"	35	1.330"	1.500"	7-1/2"	13	S41200CTFX
1-½"	41	1.750"	1.520"	9"	22	S41500CTFX

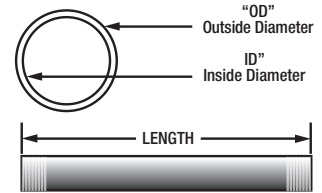

STAINLESS STEEL FLEXIBLE CONNECTORS (Type 304SS)

Flex Connector Male 90° Elbow			<i>NEMA4X</i>			
Nominal Size		Suitable for damp locations				
Trade Size	Metric Size	Wt. (lbs)	Part Number	A	B	C
½"	16	0.29	S40500FC90	2.000"	1.250"	1.750"
¾"	21	0.50	S40700FC90	2.250"	1.390"	1.750"
1"	27	0.75	S41000FC90	2.880"	1.780"	2.140"
1-¼"	35	0.98	S41200FC90	3.330"	2.250"	2.400"
1-½"	41	1.38	S41500FC90	3.720"	2.480"	2.960"

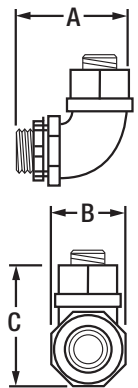

Flex Connector Male Straight			<i>NEMA4X</i>		
Nominal Size		Suitable for damp locations			
Trade Size	Metric Size	Wt. (lbs)	Part Number	A	B
½"	16	0.15	S40500FCS0	1.530"	1.200"
¾"	21	0.22	S40700FCS0	1.675"	1.500"
1"	27	0.33	S41000FCS0	1.800"	1.650"
1-¼"	35	0.66	S41200FCS0	1.900"	2.150"
1-½"	41	0.83	S41500FCS0	2.000"	2.250"

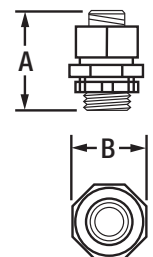

*45° Flex Connectors available in ½" and ¾".

3-PIECE STAINLESS STEEL COUPLINGS (Union) (Type 316SS)

3-Piece Couplings			
Trade Size	Metric Size	Wt. (lbs)	Part Number
½"	16	0.44	S605003U00
¾"	21	0.58	S607003U00
1"	27	0.94	S610003U00
1-½"	41	1.47	S615003U00
2"	53	2.27	S620003U00

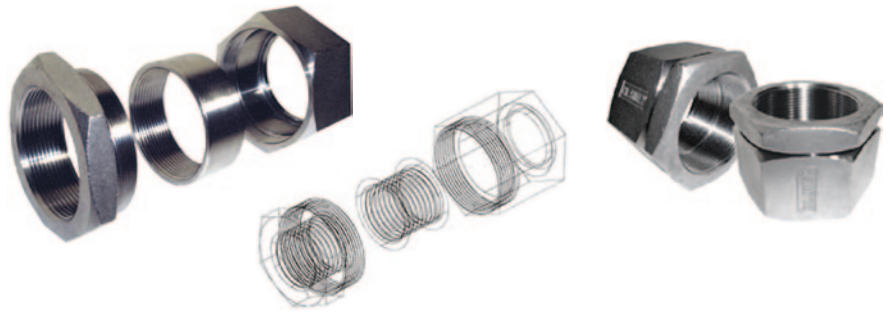

STAINLESS STEEL COUPLINGS (Type 316SS)

Standard Couplings				A
Trade Size	Metric Size	Wt. (lbs)	Part Number	
½"	16	0.17	S60500CP00	1.570"
¾"	21	0.26	S60700CP00	1.624"
1"	27	0.34	S61000CP00	2.000"
1-¼"	35	0.51	S61200CP00	2.050"
1-½"	41	0.61	S61500CP00	2.063"
2"	53	0.95	S62000CP00	2.125"
2-½"	63	1.87	S62500CP00	3.115"
3"	78	1.93	S63000CP00	3.263"
4"	103	3.97	S64000CP00	3.516"

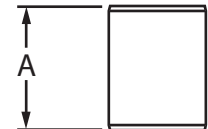

STAINLESS STEEL LINE TERMINATOR HUBS (Type 316SS)

LT Hubs			NEMA4X						
Trade Size	Metric	Wt. (lbs)	Part Number	A	B	a	T1	T2	
½"	16	0.19	S60500LT00	1.375"	1.625"	0.625"	0.5 NPT	0.5 NPS	
¾"	21	0.25	S60700LT00	1.375"	1.875"	0.625"	0.75 NPT	0.75 NPS	
1"	27	0.45	S61000LT00	1.625"	2.125"	0.625"	1 NPT	1 NPS	
1-¼"	35	0.67	S61200LT00	1.875"	2.500"	0.875"	1.25 NPT	1.25 NPS	
1-½"	41	0.72	S61500LT00	1.875"	2.625"	0.875"	1.5 NPT	1.5 NPS	
2"	53	1.08	S62000LT00	2.125"	3.125"	0.875"	2 NPT	2 NPS	
2-½"	63	1.91	S62500LT00	2.250"	3.625"	1.000"	2.5 NPT	2.5 NPS	
3"	78	2.43	S63000LT00	2.500"	4.375"	1.000"	3 NPT	3 NPS	
4"	103	4.09	S64000LT00	3.173"	5.500"	1.150"	4 NPT	4 NPS	

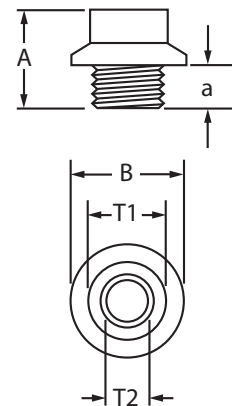

STAINLESS STEEL GROUNDING HUBS (Type 316SS)

Grounding Hubs	
Trade Size	Part Number
½"	S60500LTWG
¾"	S60700LTWG
1"	S61000LTWG
1-¼"	S61200LTWG
1-½"	S61500LTWG
2"	S62000LTWG
2-½"	S62500LTWG
3"	S63000LTWG
4"	S64000LTWG



STAINLESS STEEL CONDUIT BODIES - FORM 8 STYLE (Type 316SS)

	Trade Size	Part Number	Wt. (lbs)	Cubic Inches	A	B	C	a
LB Body	½"	S60500LB00	0.98	4"	4.960"	1.330"	2.330"	4.340"
	¾"	S60700LB00	1.25	7"	5.590"	1.560"	2.570"	4.950"
	1"	S61000LB00	1.9	11"	6.500"	1.740"	2.950"	5.680"
	1-¼"	S61200LB00	2.9	20"	7.450"	2.120"	3.820"	6.550"
	1-½"	S61500LB00	4.3	35"	8.900"	2.530"	3.960"	7.860"
	2"	S62000LB00	8	71"	11.200"	3.480"	4.290"	10.000"
	2-½"	S62500LB00	13.25	157"	13.600"	4.620"	5.770"	12.010"
	3"	S63000LB00	13.94	177"	13.300"	4.650"	5.840"	12.010"
4"	S64000LB00	29.5	380"	16.300"	5.930"	5.930"	12.010"	
TEE Body	Trade Size	Part Number	Wt. (lbs)	Cubic Inches	A	B	C	a
	½"	S60500TE00	1.26	5"	5.690"	2.210"	2.030"	4.340"
	¾"	S60700TE00	1.86	9"	6.280"	2.390"	2.300"	4.960"
	1"	S61000TE00	2.5	13"	7.330"	2.680"	2.570"	5.680"
	1-¼"	S61200TE00	3.5	24"	8.520"	3.120"	2.590"	6.550"
	1-½"	S61500TE00	5.02	35"	10.500"	3.660"	3.000"	7.860"
	2"	S62000TE00	9.82	77"	12.300"	4.660"	3.800"	10.000"
	2-½"	S62500TE00	14.32	160"	16.000"	6.130"	4.370"	12.010"
3"	S63000TE00	15	177"	16.160"	6.240"	4.370"	12.010"	
4"	S64000TE00	30	382"	18.000"	7.560"	5.830"	12.010"	
LL Body	Trade Size	Part Number	Wt. (lbs)	Cubic Inches	A	B	C	a
	½"	S60500LL00	1.04	4"	4.960"	2.200"	1.720"	4.360"
	¾"	S60700LL00	1.34	7"	5.590"	2.320"	1.950"	4.950"
	1"	S61000LL00	1.91	11"	6.500"	2.620"	2.220"	5.680"
	1-½"	S61500LL00	4.45	35"	8.900"	3.760"	3.040"	7.860"
	2"	S62000LL00	9.02	71"	11.200"	4.730"	3.860"	10.000"
LR Body	Trade Size	Part Number	Wt. (lbs)	Cubic Inches	A	B	C	a
	½"	S60500LR00	1.04	4"	4.960"	2.200"	1.720"	4.320"
	¾"	S60700LR00	1.34	7"	5.590"	2.320"	1.950"	4.950"
	1"	S61000LR00	1.91	11"	6.500"	2.620"	2.230"	5.640"
	1-½"	S61500LR00	4.45	35"	8.900"	3.760"	3.040"	7.810"
2"	S62000LR00	9.02	71"	11.200"	4.730"	3.860"	10.000"	
TB Body	Trade Size	Part Number	Wt. (lbs)	Cubic Inches	A	B	C	a
	½"	S60500TB00	1.08	5"	5.690"	1.330"	2.490"	4.320"
	¾"	S60700TB00	1.50	9"	6.280"	1.560"	2.6770"	4.950"
	1"	S61000TB00	2.28	13"	7.330"	1.740"	3.070"	5.640"
	1-½"	S61500TB00	4.90	35"	10.500"	2.530"	4.320"	7.810"
2"	S62000TB00	9.32	77"	12.300"	3.480"	4.680"	10.000"	
C Body	Trade Size	Part Number	Wt. (lbs)	Cubic Inches	A	B	C	a
	½"	S60500CE00	1.15	5"	5.690"	1.330"	1.720"	4.320"
	¾"	S60700CE00	1.64	9"	6.280"	1.560"	2.020"	4.950"
	1"	S61000CE00	2.19	13"	7.330"	1.740"	2.220"	5.640"
	1-¼"	S61200CE00	3.19	24"	8.520"	2.120"	2.630"	6.550"
	1-½"	S61500CE00	4.63	35"	10.500"	2.530"	2.740"	7.810"
2"	S62000CE00	8.66	77"	12.300"	3.480"	3.550"	10.000"	

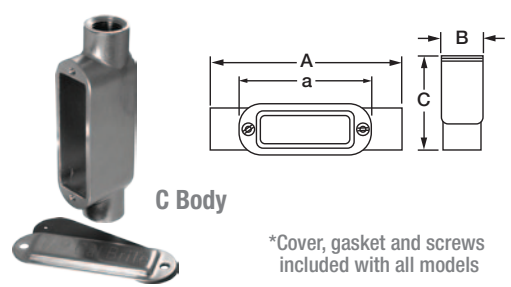
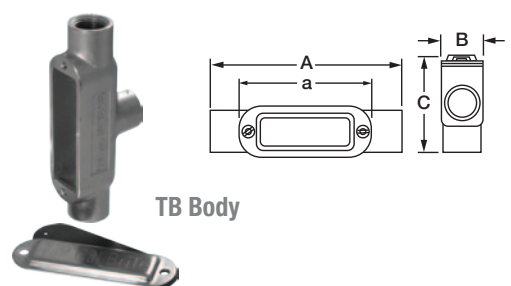
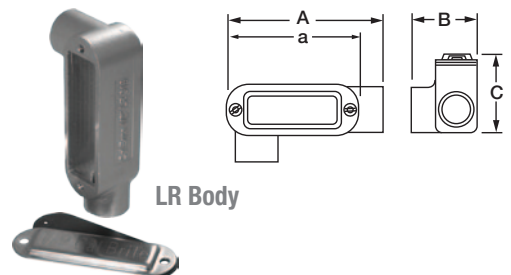
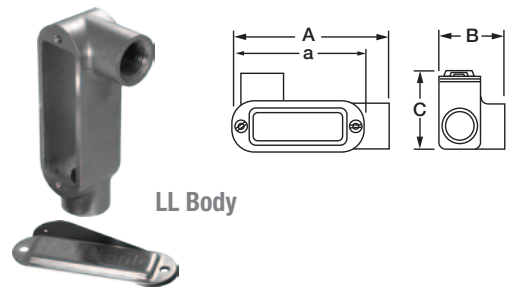
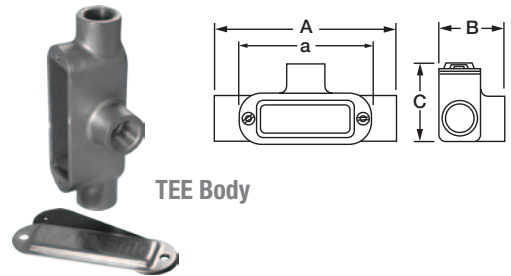
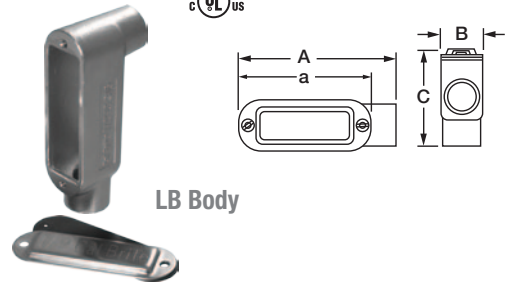

*Cover, gasket and screws included with all models

CALSTRUT™ STAINLESS STEEL STRUT

Available in other sizes, styles and gauges upon request. Available in 10' lengths.

Slotted Strut			
Trade Size	Gauge	Type	Part Number
1-5/8" x 1-5/8"	12 ga	SS304	S45810ST58
1-5/8" x 7/8"	14 ga	SS304	S45810ST78
1-5/8" x 1-5/8"	12 ga	SS316	S65810ST58
1-5/8" x 7/8"	14 ga	SS316	S65810ST78



Solid Strut			
Trade Size	Gauge	Type	Part Number
1-5/8" x 1-5/8"	12 ga	SS304	S45810SL58
1-5/8" x 7/8"	14 ga	SS304	S45810SL78
1-5/8" x 1-5/8"	12 ga	SS316	S65810SL58
1-5/8" x 7/8"	14 ga	SS316	S65810SL78



Back-To-Back Strut			
Trade Size	Gauge	Type	Part Number
1-5/8" x 1-5/8"	12 ga	SS304	S45810SB58
1-5/8" x 7/8"	14 ga	SS304	S45810SB78
1-5/8" x 1-5/8"	12 ga	SS316	S65810SB58
1-5/8" x 7/8"	14 ga	SS316	S65810SB78



Post Base for Channel	
Trade Size	Part Number
Fits 1-5/8" channel holes - 3/4" dia.	S45800PB00



STAINLESS STEEL STRUT ACCESSORIES (Type 316SS)

4-Hole Flat Angle Plate	
Hole Diameter	Part Number
9/16"	S600004BF0

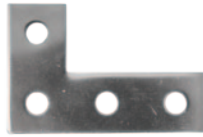

4-Hole Splice Plate	
Hole Diameter	Part Number
9/16"	S60000PL4S



3-Hole Flat Angle Plate	
Hole Diameter	Part Number
9/16"	S600003BF0



Cross Plate	
Hole Diameter	Part Number
9/16"	S60000PLCR



Tee Plate	
Hole Diameter	Part Number
9/16"	S60000PLTE

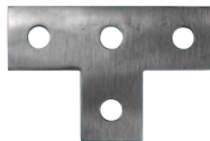

4-Hole Angle Bracket	
Hole Diameter	Part Number
9/16"	S600004B00



2-Hole Angle Bracket	
Hole Diameter	Part Number
9/16"	S600002B00



Saddle Washers	
Hole Diameter	Part Number
3/8"	S60300STSW
1/2"	S60500STSW
5/8"	S60600STSW



Channel Nuts with Spring	
Hole Diameter	Part Number
1/4"-20"	S60000CN11
3/8"-16"	S60000CN31
1/2"-13"	S60000CN41
5/8"-11"	S60000CN51
3/4"-10"	S60000CN61



U-Fitting	
Hole Diameter	Part Number
Fits 1-5/8" channel holes - 9/16" dia.	S60000UF00



STAINLESS STEEL CORD GRIP CONNECTORS (Type 304SS)

Cord Grip Connectors		
Trade Size	Cable Range	Part Number
½"	Cable Range - .125" - .188"	S40501GR00
½"	Cable Range - .188" - .250"	S40502GR00
½"	Cable Range - .250" - .312"	S40503GR00
½"	Cable Range - .312" - .375"	S40504GR00
½"	Cable Range - .375" - .438"	S40505GR00
½"	Cable Range - .438" - .500"	S40506GR00
½"	Cable Range - .500" - .562"	S40507GR00
½"	Cable Range - .562" - .625"	S40508GR00
¾"	Cable Range - .438" - .500"	S40701GR00
¾"	Cable Range - .500" - .562"	S40702GR00
¾"	Cable Range - .500" - .625"	S40703GR00
¾"	Cable Range - .562" - .688"	S40704GR00
¾"	Cable Range - .625" - .750"	S40705GR00
¾"	Cable Range - .688" - .812"	S40706GR00
1"	Cable Range - .438" - .562"	S41001GR00
1"	Cable Range - .500" - .562"	S41002GR00
1"	Cable Range - .500" - .625"	S41003GR00
1"	Cable Range - .562" - .688"	S41004GR00
1"	Cable Range - .625" - .750"	S41005GR00
1"	Cable Range - .688" - .812"	S41006GR00
1"	Cable Range - .750" - .875"	S41007GR00
1"	Cable Range - .812" - .938"	S41008GR00
1"	Cable Range - .875" - 1.000"	S41009GR00
1-¼"	Cable Range - .562" - .688"	S41201GR00
1-¼"	Cable Range - .688" - .812"	S41202GR00
1-¼"	Cable Range - .750" - .875"	S41203GR00
1-¼"	Cable Range - .875" - 1.000"	S41204GR00
1-¼"	Cable Range - 1.000" - 1.125"	S41205GR00
1-¼"	Cable Range - 1.125" - 1.250"	S41206GR00
1-¼"	Cable Range - 1.250" - 1.375"	S41207GR00
1-½"	Cable Range - .562" - .688"	S41501GR00
1-½"	Cable Range - .688" - .812"	S41502GR00
1-½"	Cable Range - .750" - .875"	S41503GR00
1-½"	Cable Range - .875" - 1.000"	S41504GR00
1-½"	Cable Range - 1.000" - 1.125"	S41505GR00
1-½"	Cable Range - 1.125" - 1.250"	S41506GR00
1-½"	Cable Range - 1.250" - 1.375"	S41507GR00
2"	Cable Range - 1.250" - 1.375"	S42001GR00
2"	Cable Range - 1.438" - 1.562"	S42002GR00
2"	Cable Range - 1.562" - 1.688"	S42003GR00
2"	Cable Range - 1.688" - 1.812"	S42004GR00
2"	Cable Range - 1.812" - 1.938"	S42005GR00
2"	Cable Range - 1.938" - 2.062"	S42006GR00
2"	Cable Range - 2.062" - 2.188"	S42007GR00
2"	Cable Range - 2.188" - 2.312"	S42008GR00
2"	Cable Range - 2.312" - 2.438"	S42009GR00



STAINLESS STEEL CORD GRIP CONNECTORS WITH MESH (Type 304 SS)

Cord Grip Connectors with Mesh		
Trade Size	Cable Range	Part Number
1/2"	Cable Range - .188" - .250"	S40502GRWM
1/2"	Cable Range - .250" - .312"	S40503GRWM
1/2"	Cable Range - .312" - .375"	S40504GRWM
1/2"	Cable Range - .375" - .438"	S40505GRWM
1/2"	Cable Range - .438" - .500"	S40506GRWM
1/2"	Cable Range - .500" - .562"	S40507GRWM
1/2"	Cable Range - .562" - .625"	S40508GRWM
3/4"	Cable Range - .438" - .500"	S40701GRWM
3/4"	Cable Range - .500" - .562"	S40702GRWM
3/4"	Cable Range - .500" - .625"	S40703GRWM
3/4"	Cable Range - .562" - .688"	S40704GRWM
3/4"	Cable Range - .625" - .750"	S40705GRWM
3/4"	Cable Range - .688" - .812"	S40706GRWM
1"	Cable Range - .438" - .562"	S41001GRWM
1"	Cable Range - .500" - .562"	S41002GRWM
1"	Cable Range - .500" - .625"	S41003GRWM
1"	Cable Range - .562" - .688"	S41004GRWM
1"	Cable Range - .625" - .750"	S41005GRWM
1"	Cable Range - .688" - .812"	S41006GRWM
1"	Cable Range - .750" - .875"	S41007GRWM
1"	Cable Range - .812" - .938"	S41008GRWM
1"	Cable Range - .875" - 1.000"	S41009GRWM
1-1/4"	Cable Range - .562" - .688"	S41201GRWM
1-1/4"	Cable Range - .688" - .812"	S41202GRWM
1-1/4"	Cable Range - .750" - .875"	S41203GRWM
1-1/4"	Cable Range - .875" - 1.000"	S41204GRWM
1-1/4"	Cable Range - 1.000" - 1.125"	S41205GRWM
1-1/4"	Cable Range - 1.125" - 1.250"	S41206GRWM
1-1/4"	Cable Range - 1.250" - 1.375"	S41207GRWM
1-1/2"	Cable Range - .562" - .688"	S41501GRWM
1-1/2"	Cable Range - .688" - .812"	S41502GRWM
1-1/2"	Cable Range - .750" - .875"	S41503GRWM
1-1/2"	Cable Range - .875" - 1.000"	S41504GRWM
1-1/2"	Cable Range - 1.000" - 1.125"	S41505GRWM
1-1/2"	Cable Range - 1.125" - 1.250"	S41506GRWM
1-1/2"	Cable Range - 1.250" - 1.375"	S41507GRWM
2"	Cable Range - 1.250" - 1.375"	S42001GRWM
2"	Cable Range - 1.438" - 1.562"	S42002GRWM
2"	Cable Range - 1.562" - 1.688"	S42003GRWM
2"	Cable Range - 1.688" - 1.812"	S42004GRWM
2"	Cable Range - 1.812" - 1.938"	S42005GRWM
2"	Cable Range - 1.938" - 2.062"	S42006GRWM
2"	Cable Range - 2.062" - 2.188"	S42007GRWM
2"	Cable Range - 2.188" - 2.312"	S42008GRWM
2"	Cable Range - 2.312" - 2.438"	S42009GRWM



STAINLESS STEEL DEVICE BOXES c(UL)us

(Type 316SS) S = Shallow, D = Deep

FS Single Gang Box		
3/4" FDC	Wt. (lbs)	Cubic Inch.
S60700FS00	2.03	18"



FD Single Gang Box		
3/4" FD	Wt. (lbs)	Cubic Inch.
S60700FD00	2.45	25"



FDC Single Gang Box		
3/4" FDCS	Wt. (lbs)	Cubic Inch.
S60700FDCS	2.1	25"



FDC Double Gang Box		
3/4" FDC	Wt. (lbs)	Cubic Inch.
S60700FDCD	2.45	25"



FDCC & FSCC Single Gang Boxes				
Model	Size	Part Number	Wt. (lbs)	Cubic Inch.
FDCC	3/4"	S60700FDCC	2.50	25"
FSCC	3/4"	S60700FSCC	2.06	18"



FDX & FSX Single Gang Boxes				
Model	Size	Part Number	Wt. (lbs)	Cubic Inch.
FDX	3/4"	S60700FDX0	2.60	25"
FSX	3/4"	S60700FSX0	2.22	18"



FSCT & FDCT Gang Boxes			
Model	Part Number	Wt. (lbs)	Cubic Inch.
FSCT	S60700FSCT	2.27	18"
FDCT	S60700FDCT	2.66	25"



In-Use Boxes	
3/4" In-Use	Wt. (lbs)
S60700FVCS	2.65
S60700FVCD	3.00



(Suitable for Damp Environments)

STAINLESS STEEL DEVICE BOX COVERS

STAINLESS STEEL DEVICE BOX PLATES

Duplex Receptacle (Horizontal) #S607HDCVRS

Two Gang Blank (2 Gang) #S607BLPLTD

GFCI Receptacle (Vertical) #S607VGCVRS

Duplex Receptacle (Vertical) #S607VDCVRS

Single Gang Blank (1 Gang) #S607BLPLTS

Duplex Receptacle (Horizontal) #S607HDCVLS

GFCI Receptacle (Horizontal) #S607VGCVLS

Toggle Switch (Vertical) #S6071TCVRS

Two Toggle Switch (Vertical) #S6072TCVRD

Toggle Switch (Horizontal) #S6071TCVLS

Two Toggle Switch (2 Gang) #S6072PLTD

Two Toggle Receptacle (2 Gang) #S6072DPLTD

One Toggle Switch (1 Gang) #S6071PLTS

One Duplex Receptacle (1 Gang) #S6072DPLTS

One Toggle Switch & One GFCI Receptacle (2 Gang) #S607TPLTD

Two GFCI Receptacle (2 Gang) #S6072GPLTD

One GFCI Receptacle (1 Gang) #S6071GPLTS

STAINLESS STEEL WASHERS, NUTS & SCREWS (Type 316SS)

Locknuts	
Trade Size	Part Number
1/2"	S60500LN00
3/4"	S60700LN00
1"	S61000LN00
1-1/4"	S61200LN00
1-1/2"	S61500LN00
2"	S62000LN00
2-1/2"	S62500LN00
3"	S63000LN00
4"	S64000LN00



Grounding Locknuts	
Trade Size	Part Number
1/2"	S60500LNWG
3/4"	S60700LNWG
1"	S61000LNWG
1-1/4"	S61200LNWG
1-1/2"	S61500LNWG
2"	S62000LNWG
2-1/2"	S62500LNWG
3"	S63000LNWG
4"	S64000LNWG



Standard Washers	
Trade Size	Part Number
1/4"	S60200WA00
3/8"	S60300WA00
1/2"	S60500WA00
5/8"	S60600WA00



Hex Nuts	
Trade Size	Part Number
1/4"	S60200HN00
3/8"	S60300HN00
1/2"	S60500HN00
5/8"	S60600HN00



Lock Washers	
Trade Size	Part Number
1/4"	S60200LW00
3/8"	S60300LW00
1/2"	S60500LW00
5/8"	S60600LW00



Square Washers	
Trade Size	Part Number
1/4"	S60200SW00
3/8"	S60300SW00
1/2"	S60500SW00
5/8"	S60600SW00

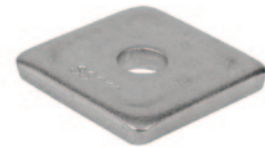

STAINLESS STEEL RODS & SCREWS

Threaded Rod		
Trade Size	Type 304 Part Number	Type 316 Part Number
1/4"	S40212TR00	S60212TR00
3/8"	S40312TR00	S60312TR00
1/2"	S40512TR00	S60512TR00



Hex Head Cap Screws	
Trade Size	Part Number
Various	S60000HC00



Slotted Machine Screws 316SS	
Trade Size	Part Number
Various	S60000MS00



STAINLESS STEEL CLAMPS (Type 316SS)

Split Ring Clamps	
Trade Size	Part Number
1/2"	S60500SP00
3/4"	S60700SP00
1"	S61000SP00
1-1/4"	S61200SP00
1-1/2"	S61500SP00
2"	S62000SP00
2-1/2"	S62500SP00
3"	S63000SP00
4"	S64000SP00



Split Ring Extensions		
Trade Size	Description	Part Number
3/8" x 2"	For Clamps - 1/2" - 2"	S60302SPX0
3/8" x 4"	For Clamps - 1/2" - 2"	S60304SPX0
3/8" x 6"	For Clamps - 1/2" - 2"	S60306SPX0
1/2" x 2"	For Clamps - 2-1/2" - 4"	S60502SPX0
1/2" x 4"	For Clamps - 2-1/2" - 4"	S60504SPX0
1/2" x 6"	For Clamps - 2-1/2" - 4"	S60506SPX0

Split Ring Mounting Plates		
Trade Size	Description	Part Number
3/8"	For Clamps - 1/2" - 2"	S60300SPMP
1/2"	For Clamps - 2-1/2" - 4"	S60500SPMP



Conduit Hangers	
Trade Size	Part Number
1/2"	S60500MH00
3/4"	S60700MH00
1"	S61000MH00
1-1/4"	S61200MH00
1-1/2"	S61500MH00
2"	S62000MH00
2-1/2"	S62500MH00
3"	S63000MH00
4"	S64000MH00

(Also available in SS EMT)



Parallel Clamps	
Trade Size	Part Number
3/4"	S60700PC00
1"	S61000PC00



Strut Clamps	
Trade Size	Part Number
1/2"	S60500SC00
3/4"	S60700SC00
1"	S61000SC00
1-1/4"	S61200SC00
1-1/2"	S61500SC00
2"	S62000SC00
2-1/2"	S62500SC00
3"	S63000SC00
3-1/2"	S63500SC00
4"	S64000SC00

(Also available in SS EMT)



Right Angle Clamps	
Trade Size	Part Number
1/2"	S60500RA00
3/4"	S60700RA00
1"	S61000RA00
1-1/4"	S61200RA00
1-1/2"	S61500RA00
2"	S62000RA00
2-1/2"	S62500RA00
3"	S63000RA00
3-1/2"	S63500RA00
4"	S64000RA00



Right Angle Beam Clamp	
Trade Size	Part Number
1-5/8" x 1-5/8"	S60000RB00

Beam Clamps	
Trade Size	Part Number
1/4" - 20"	S60200BC00
3/8" - 16"	S60300BC00
1/2" - 13"	S60500BC00

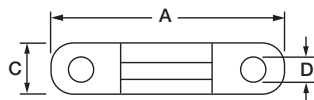

STAINLESS STEEL STRAPS (Type 316SS)

2-Hole Straps (Also Available in SS EMT)					
Trade Size	Part Number	A	B	C	Bolt Hole
1/2"	S605002S00	2.427"	0.627"	0.840"	1/4"
3/4"	S607002S00	2.925"	0.748"	1.050"	1/4"
1"	S610002S00	3.370"	0.749"	1.300"	1/4"
1-1/4"	S612002S00	4.440"	0.876"	1.660"	5/16"
1-1/2"	S615002S00	4.440"	1.240"	1.900"	5/16"
2"	S620002S00	5.290"	1.240"	2.370"	5/16"
2-1/2"	S625002S00	6.119"	1.250"	2.874"	1/4"
3"	S630002S00	6.727"	1.250"	3.500"	1/4"
4"	S640002S00	8.947"	1.250"	4.500"	1/4"



1-Hole Straps (Also available in SS EMT)					
Trade Size	Part Number	A	B	C	Bolt Hole
1/2"	S605001S00	0.625"	0.075"	0.840"	1/4"
3/4"	S607001S00	0.750"	0.090"	1.050"	1/4"
1"	S610001S00	0.875"	0.090"	1.300"	1/4"
1-1/4"	S612001S00	0.875"	0.100"	1.660"	1/2"
1-1/2"	S615001S00	1.000"	0.125"	1.900"	1/2"
2"	S620001S00	1.125"	0.125"	2.370"	9/16"
2-1/2"	S625001S00	1.250"	0.150"	2.874"	9/16"
3"	S630001S00	1.250"	0.150"	3.500"	9/16"
4"	S640001S00	1.250"	0.180"	4.500"	9/16"

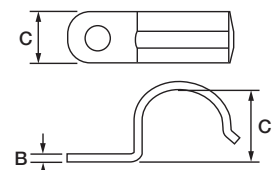

MISCELLANEOUS

Counter-Sunk Hex Plugs

Trade Size	Part Number	Length
1/2"	S60500CSHP	0.375"
3/4"	S60700CSHP	0.563"
1"	S61000CSHP	0.625"
1-1/4"	S61200CSHP	0.750"
1-1/2"	S61500CSHP	1.000"
2"	S62000CSHP	1.000"
3"	S63000CSHP	1.000"
4"	S64000CSHP	1.000"



Box Connectors

Trade Size	Part Number
1/2"	S60500CH00
3/4"	S60700CH00
1"	S61000CH00
1-1/4"	S61200CH00
1-1/2"	S61500CH00
2"	S62000CH00
2-1/2"	S62500CH00
3"	S63000CH00
3-1/2"	S63500CH00
4"	S64000CH00



Threaded Conduit Caps

Trade Size	Part Number
1/2"	S60500CA00
3/4"	S60700CA00
1"	S61000CA00
1-1/4"	S61200CA00
1-1/2"	S61500CA00
2"	S62000CA00
2-1/2"	S62500CA00
3"	S63000CA00
4"	S64000CA00



Pulling Elbows

Trade Size	Part Number	Wt. (lbs)
3/4"	S60700P900	0.31
1"	S61000P900	0.64



Rod Couplings

Trade Size	Part Number
1/4"	S60200RC00
3/8"	S60300RC00
1/2"	S60500RC00
3/4"	S60700RC00



Conduit Body Cover, Gasket & Screw Sets

Trade Size	Part Number	Length	Wt. (lbs)
1/2"	S60500CG00	4.320"	0.11
3/4"	S60700CG00	4.950"	0.16
1"	S61000CG00	5.640"	0.21
1-1/2"	S61500CG00	7.810"	0.36
2"	S62000CG00	10.000"	0.65



Face Bushings

Trade Size	Part Number
3/4" x 1/2"	S60700FB05
1" x 1/2"	S61000FB05
1" x 3/4"	S61000FB07
1-1/4" x 3/4"	S61200FB07
1-1/4" x 1"	S61200FB10
1-1/2" x 1"	S61500FB10
1-1/2" x 1-1/4"	S61500FB12
2" x 1"	S62000FB10
2" x 1-1/4"	S62000FB12
2" x 1-1/2"	S62000FB15



*SS Hex Bushings also available.

Standard U-Bolts

(Figure 137 Style)

Trade Size	Part Number	A	B	T	a
1/2"	S60500UB00	3.219"	0.938"	1/4"-20	2.500"
3/4"	S60700UB00	3.313"	1.125"	1/4"-20	2.500"
1"	S61000UB00	3.438"	1.375"	1/4"-20	2.500"
1-1/4"	S61200UB00	3.719"	1.688"	3/8"-16	2.500"
1-1/2"	S61500UB00	4.000"	2.000"	3/8"-16	2.500"
2"	S62000UB00	4.469"	2.438"	3/8"-16	2.500"
2-1/2"	S62500UB00	5.219"	2.938"	1/2"-13	3.000"
3"	S63000UB00	5.782"	3.563"	1/2"-13	3.000"
3-1/2"	S63500UB00	6.219"	4.063"	1/2"-13	3.000"
4"	S64000UB00	6.782"	4.563"	1/2"-13	3.000"

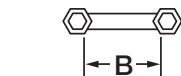
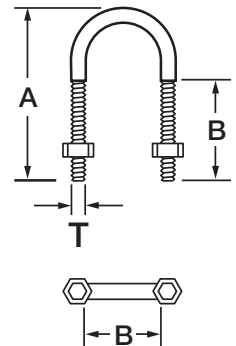
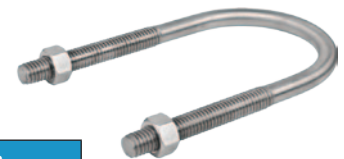

Calbrite™

A Division of CALPIPE INDUSTRIES

INDUSTRIES SERVED

Food, Dairy, Beverage and Seafood Industries

Water & Wastewater Treatment Facilities

Mining

Marine & Coastal Facilities

Chemical Plants

Petrochemical

Steel Mills

Offshore Platforms

Breweries

Cooling Towers

Transportation

Pharmaceuticals & Cosmetics

Architectural & Structural Design

Power Plants

Pulp and Paper Mills

Fertilizer Plants

Along with other corrosive environments

UL6A, UL514B, NEMA 4X, ANSI



MIDWEST

2207 165th Street
Hammond, IN 46320
(219) 844-6800
(800) 536-2248
(219) 844-6884 fax

WEST COAST

12021 Woodruff Avenue
Downey, CA 90241
(562) 803-4388
(800) 225-7473
(562) 803-9883 fax

SOUTHEAST

2434 Destiny Way, Suite 2
Odessa, FL 33556
(219) 844-6800
(800) 536-2248
(219) 844-6884 fax